

GAOTIAN高田  
高新技术企业



76 多年专注只为提供更好产品

www.gaotian-pump.com

# STAINLESS STEEL SEWAGE PUMP 不锈钢排污泵



上海高田制泵有限公司  
SHANGHAI GAOTIAN PUMP MANUFACTURE CO.,LTD.

☎ 销售电话:  
021-57239999 67231155 67231166

📍 公司地址:  
上海市金山区亭林镇林盛路178号

📠 图文传真:  
021-37283677

🌐 公司官网:  
www.gaotian-pump.com



所有资料只作参考用途，高田有权更改产品设计，我们保留对产品的更换的权利，更多资料请与高田技术部联系咨询，高田对选型手册拥有最终解释权。

上海高田制泵有限公司  
SHANGHAI GAOTIAN PUMP MANUFACTURE CO.,LTD.



## 企业简介

上海高田制泵有限公司是上海市高新技术企业，公司成立于2003年01月，坐落于东方国际大都市——上海金山，注册资金10000万元，公司集科研、生产、销售、服务于一体。公司已在全国设立了一百多个销售处和售后服务中心，拥有完善的质量服务体系，以完善的销售服务网络为客户提供方便、快捷的服务。

在质量体系的实施中，公司的产品严格按照标准组织生产，并通过先进的微机控制系统测试，来保障每一台水泵的合格出厂。公司的产品涵盖排污泵、清水泵、空调泵、污水泵、化工泵、油泵、无负压等成套给水设备和控制柜，多达二十多个系列一千多个品种，广泛应用于市政工程、农业、炼油、冶金、电站、水厂、宾馆、工矿企业、建筑给排水、暖通、制冷、排污、消防、石油与化工、医药食品卫生等行业，本厂产品已销售到越南、泰国、伊拉克及我国台湾省等地区。在客户中建立了良好的信誉。以可靠的质量和合理的价格深受广大用户青睐。

不断地“创新和发展”是我们的宗旨，公司及时跟踪泵业的新动态，了解和吸收新技术、新产品。近年来连续在市场上先后推出了GTGW无负压、GTP污水提升器、GTPP预制泵站、GTOW油水分离器、GTB型便拆式离心泵，GTSB型立式便拆式双吸泵，GTOS型中开式双吸泵，深受广大用户的欢迎。公司同时可为用户单独设计制造特殊参数和特殊材质的各类水泵。

我们将继续以新的产品、卓越的品质来回馈广大客户，以“没有最好，只有更好”的服务宗旨，为您提供优良的产品和完善的售前、售后服务。



## 选型目录

- |  |  |
|--|--|
| <p><b>01</b>   Cutting Type Sewage Submersible Pump<br/>WQ(D)-QG(切割式)污水污物潜水电泵</p>  | <p><b>29</b>   Stainless steel precision casting<br/>High-lift sewage pump (Wire Effluent)<br/>WQ(D)X-S不锈钢精密铸造高扬程污水泵(丝口出水)</p>                         |
| <p><b>07</b>   Stainless steel precision casting Sewage<br/>Submersible Pump (GB Flange)<br/>WQ(D)-S不锈钢精密铸造污水污物潜水电泵(国标法兰)</p>                | <p><b>31</b>   Stainless steel precision casting<br/>Small submersible electric pump (Wire Effluent)<br/>Q(D)X-S不锈钢精密铸造小型潜水电泵(丝口出水)</p>                |
| <p><b>13</b>   Flameproof submersible sewage pump<br/>BWQ隔爆型潜水排污泵</p>  | <p><b>33</b>   Stainless steel small submersible pump (stamping parts)<br/>WQ/Q(D)X-S不锈钢小型潜水电泵(冲压件)</p>  |
| <p><b>18</b>   Stainless steel precision casting Sewage<br/>Automatic stirring sewage pump (GB Flange)<br/>JYWQ(D)-S不锈钢精密铸造自动搅匀排污泵(国标法兰)</p> | <p><b>35</b>   Stainless steel precision casting Oil-filled submersible pump<br/>QY-S不锈钢精密铸造油浸式潜水电泵</p>  |
| <p><b>23</b>   Stainless Steel Precision Casting Sewage<br/>Cutting Sewage Pump (GB Flange)<br/>WQ(S)-SQG不锈钢精密铸造切割式污水泵(国标法兰)</p>             | <p><b>37</b>   Coupling<br/>耦合装置</p>   |
| <p><b>25</b>   Stainless steel precision casting submersible<br/>sewage pump B section<br/>WQ(D)-S不锈钢精密铸造污水污物潜水电泵B款</p>                      | <p><b>38</b>   Stainless Steel Pump Common Mechanical Seal, Sealing Mate<br/>Rial Corrosion Resistance Reference Table<br/>不锈钢泵常见机械密封、密封材料的耐腐蚀性参考表</p> |
| <p><b>27</b>   Stainless steel precision casting<br/>submersibles ewage pump(Wire Effluent)<br/>WQ(D)-S不锈钢精密铸造污水污物潜水电泵(丝口出水)</p>             | <p><b>39</b>   Stainless steel material corrosion resistance reference table<br/>不锈钢材料耐腐蚀性参考表</p>  |

**WQ(D)-QG**  
**Cutting Type Sewage Submersible Pump**  
**(切割式) 污水污物潜水电泵**

**产品概述/Product Description**

WQ(D)-QG带切割装置潜水排污泵采用开式叶轮，具有排污通过能力特别强，流量大，扬程高，切割性能好等特点。能将污水中的长纤维、塑料、纸、带、布条、稻草、绳子等杂质切碎后排出，采用最先进的办法，设计成最合理的水力特性，使电泵可以全扬程运行，优良的干式电机和水泵的最佳组合。电泵采用高质量的碳化硅氟橡胶机。

1. 双端面机械密封和骨架油封组面部位，不得超过电动机高度的1/2，抽送污物温度不超过40℃。该系列污水污物潜水排污泵主要用于排送生活废水、污水、人类尿及含有短纤维纸屑、木屑、淀粉、泥沙、矿石粒等固体悬浮物和非腐蚀性介质，被抽送液体温度不超过40℃，密度不大于1200kg/m<sup>3</sup>，PH值5~9。该排污泵采用双端面机械密封和开式叶轮。
2. 20铬镍钼材质的合金刀盘和叶轮，耐磨损、不堵塞、不缠绕、具有体积小、结构紧凑、携带方便等优点。

WQ(D)-QG belt cutting device submersible sewage pump adopts open impeller, which has the characteristics of particularly strong sewage discharge, large flow, high head and good cutting performance. It can cut up and discharge the long fibers, plastic, paper, belt, cloth strip, straw, rope and other impurities in the sewage. It adopts the most advanced method to design the most reasonable hydraulic characteristics, So that the electric pump can run at full head, making the best combination of dry motor and water pump. The electric pump uses a high quality silicon carbide fluoro rubber machine.

1. The surface of the double-end mechanical seal and the skeleton oil seal shall not exceed 1/2 of the height of the motor, and the temperature of the pumped dirt shall not exceed 40°C. The series of sewage and sewage submersible sewage pumps are mainly used for discharging domestic waste water, sewage, human excrement and solid suspended solids and non-corrosive media containing short fiber paper scraps, wood chips, starch, sediment, ore particles, and pumped liquid. The temperature does not exceed 40°C the density is not more than 1200 kg/m<sup>3</sup>, PH value 5~9. The sewage pump uses double mechanical seal and open impeller.
2. 20 Chromium-nickel-molybdenum (CrNiMo) alloy cutter disc and impeller are resistant to wear, non-blocking, non-winding, small size, compact structure and convenient carrying.

**使用条件/Conditions Of Use**

1. 以叶轮中心为准，潜入水下深度不得超过5m；
2. 输送介质温度不高于60℃；
3. 输送介质的PH值304(4-10),316(4-13)；
4. 输送介质的运动黏度为7x10<sup>-7</sup>~23x10<sup>-6</sup>m<sup>2</sup>/S

产品材料耐腐蚀性能详情请参考P39-40

1. According to the center of the impeller, the max immersion depth is 5m
  2. Max temperature of the conveying is 60°C
  3. The PH value of convey temperature is 304(4-10),316(4-13)
  4. Kinematic viscosity of transport medium is 7x10<sup>-7</sup>~23x10<sup>-6</sup>m<sup>2</sup>/S
- Please refer to P39-40 for details of corrosion resistance of product materials.

**型号说明/Model Description**

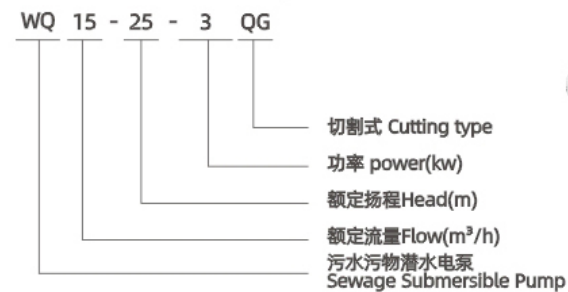

小流量曲线图 / Small flow

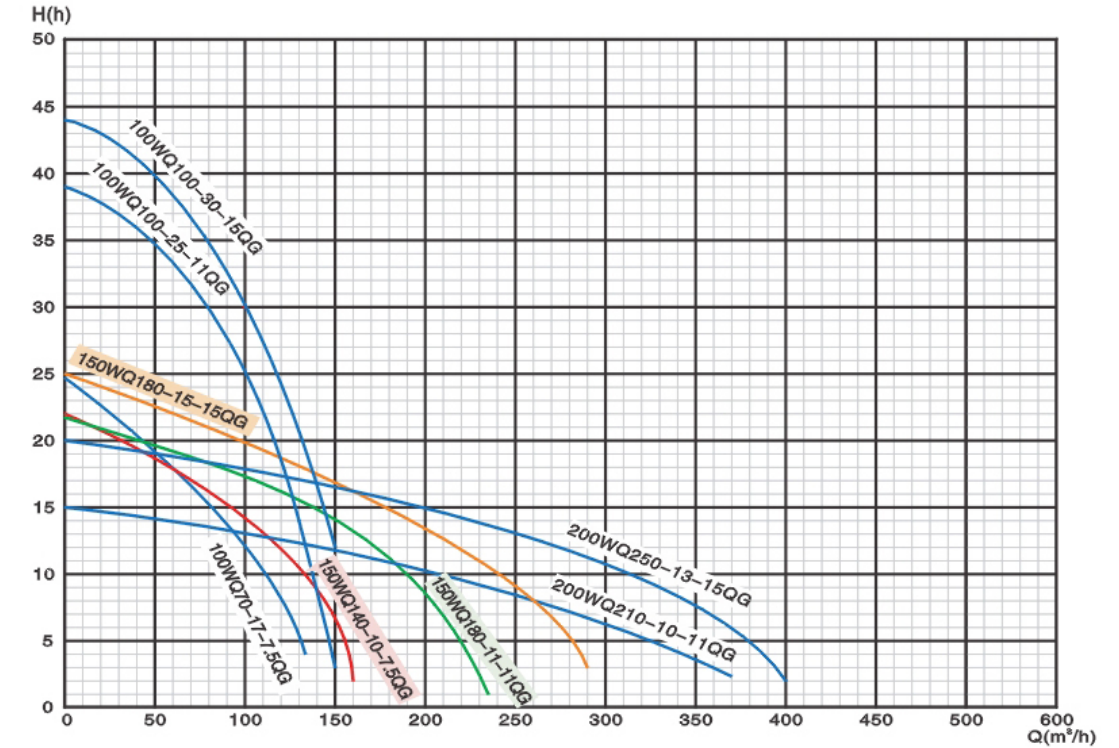

大流量曲线图 / Large flow

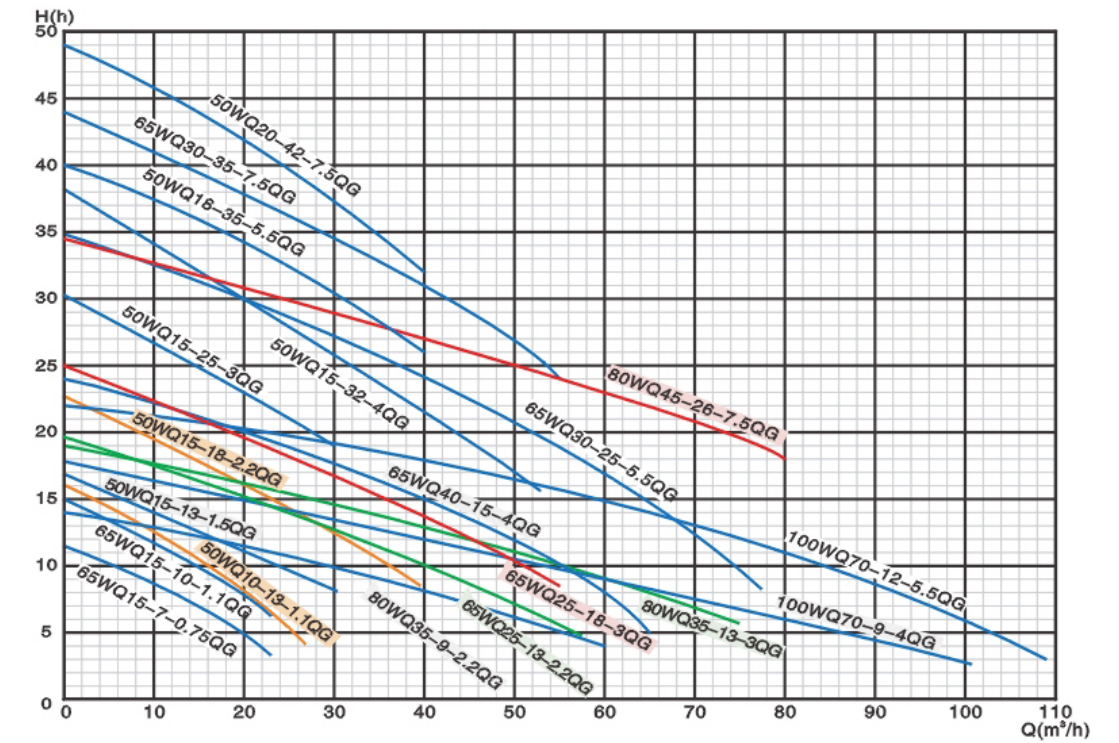

技术参数/Technical Parameters

产品型号 Model	额定流量 Flow (m <sup>3</sup> /h)	额定扬程 Lift (m)	功率 Rate power (kw)	电压 Rated voltage (V)	转速 Rotating speed (r/min)	口径 caliber (mm)	包装尺寸 长×宽×高 Package dimensions Length × width × height (cm)
WQ(D)10-10-0.75QG	10	10	0.75	220/380	2850	50	54×22×25
WQ(D)15-7-0.75QG	15	7	0.75	220/380	2850	65	54×22×25
WQ(D)10-13-1.1QG	10	13	1.1	220/380	2850	50	54×22×25
WQ(D)15-10-1.1QG	15	10	1.1	220/380	2850	65	54×22×25
WQ(D)15-13-1.5QG	15	13	1.5	220/380	2850	50	58×22×26
WQ(D)25-10-1.5QG	25	10	1.5	220/380	2850	65	58×22×26
WQD15-18-2.2QG	15	18	2.2	220	2850	50	58×22×26
WQD25-13-2.2QG	25	13	2.2	220	2850	65	58×22×26
WQD35-9-2.2QG	35	9	2.2	220	2850	80	58×22×26
WQ15-18-2.2QG	15	18	2.2	380	2850	50	58×22×26
WQ25-13-2.2QG	25	13	2.2	380	2850	65	58×22×26
WQ35-9-2.2QG	35	9	2.2	380	2850	80	58×22×26
WQ15-25-3QG	15	25	3	380	2850	50	64×24×28
WQ25-18-3QG	25	18	3	380	2850	65	64×24×28
WQ35-13-3QG	35	13	3	380	2850	80	64×24×28
WQ15-32-4QG	15	32	4	380	2850	50	71×28×34
WQ40-15-4QG	40	15	4	380	2850	65	71×28×34
WQ50-12-4QG	50	12	4	380	2850	80	71×28×34
WQ70-9-4QG	70	9	4	380	2850	100	71×28×34
WQ18-35-5.5QG	18	35	5.5	380	2850	50	79×28×34
WQ30-25-5.5QG	30	25	5.5	380	2850	65	79×28×34
WQ50-16-5.5QG	50	16	5.5	380	2850	80	79×28×34
WQ70-12-5.5QG	70	12	5.5	380	2850	100	79×28×34
WQ20-43-7.5QG	20	43	7.5	380	2850	50	81×33×39
WQ30-35-7.5QG	30	35	7.5	380	2850	65	81×33×39
WQ45-22-7.5QG	45	22	7.5	380	2850	80	81×33×39
WQ70-17-7.5QG	70	17	7.5	380	2850	100	81×33×39
WQ140-10-7.5QG	140	10	7.5	380	2850	150	81×33×39
WQ60-30-11QG	60	30	11	380	2900	80	92×33×39
WQ80-25-11QG	80	25	11	380	2900	100	92×33×39
WQ100-20-11QG	100	20	11	380	2900	150	92×33×39
WQ60-40-15QG	60	40	15	380	2900	80	92×33×39
WQ80-35-15QG	80	35	15	380	2900	100	92×33×39
WQ100-25-15QG	100	25	15	380	2900	150	92×33×39

技术参数/Technical Parameters

产品型号 Model	额定流量 Flow (m <sup>3</sup> /h)	额定扬程 Lift (m)	功率 Rate power (kw)	电压 Rated voltage (V)	转速 Rotating speed (r/min)	口径 caliber (mm)	包装尺寸 长×宽×高 Package dimensions Length × width × height (cm)
WQ100-25-11QG	100	25	11	380	1450	100	50×55×110
WQ180-11-11QG	180	11	11	380	1450	150	50×55×110
WQ210-9-11QG	210	9	11	380	1450	200	50×55×110
WQ100-30-15QG	100	30	15	380	1450	100	50×55×110
WQ180-15-15QG	180	15	15	380	1450	150	50×55×110
WQ250-11-15QG	250	11	15	380	1450	200	50×55×110
WQ100-35-18.5QG	100	35	18.5	380	1450	100	50×60×115
WQ180-20-18.5QG	180	20	18.5	380	1450	150	50×60×115
WQ250-15-18.5QG	250	15	18.5	380	1450	200	50×60×115
WQ100-40-22QG	100	40	22	380	1450	100	50×60×115
WQ200-22-22QG	200	22	22	380	1450	150	50×60×115
WQ300-16-22QG	300	16	22	380	1450	200	50×60×115
WQ100-45-30QG	100	45	30	380	1450	100	/
WQ180-30-30QG	180	30	30	380	1450	150	/
WQ250-22-30QG	250	22	30	380	1450	200	/
WQ500-12-30QG	500	12	30	380	1450	250	/
WQ120-50-37QG	120	50	37	380	1450	100	/
WQ200-35-37QG	200	35	37	380	1450	150	/
WQ300-28-37QG	300	28	37	380	1450	200	/
WQ600-12-37QG	600	12	37	380	1450	250	/
WQ100-57-45QG	100	57	45	380	1450	100	/
WQ200-40-45QG	200	40	45	380	1450	150	/
WQ300-32-45QG	300	32	45	380	1450	200	/
WQ600-15-45QG	600	15	45	380	1450	250	/
WQ100-65-55QG	100	65	55	380	1450	100	/
WQ180-50-55QG	180	50	55	380	1450	150	/
WQ300-40-55QG	300	40	55	380	1450	200	/
WQ600-20-55QG	600	20	55	380	1450	250	/

技术参数/Technical Parameters

产品型号 Model	额定流量 Flow (m³/h)	额定扬程 Lift (m)	功率 Rate power (kw)	电压 Rated voltage (V)	转速 Rotating speed (r/min)	口径 caliber (mm)	包装尺寸 长×宽×高 Package dimensions Length × width × height (cm)
WQ(D)10-10-0.75	10	10	0.75	220/380	2850	50	54×22×25
WQ(D)7-15-1.1	7	15	1.1	220/380	2850	50	54×22×25
WQ(D)15-15-1.5	15	15	1.5	220/380	2850	50	58×22×26
WQ(D)25-7-1.5	25	7	1.5	220/380	2850	65	58×22×26
WQ(D)15-20-2.2	15	20	2.2	220/380	2850	50	58×22×26
WQ(D)25-15-2.2	25	15	2.2	220/380	2850	65	58×22×26
WQ(D)40-9-2.2	40	9	2.2	220/380	2850	80	58×22×26
WQ15-25-3	15	25	3	380	2850	50	64×24×28
WQ25-20-3	25	20	3	380	2850	65	64×24×28
WQ40-15-3	40	15	3	380	2850	80	64×24×28
WQ15-32-4	15	32	4	380	2850	50	71×28×34
WQ25-25-4	25	25	4	380	2850	65	71×28×34
WQ40-18-4	40	18	4	380	2850	80	71×28×34
WQ50-15-4	50	15	4	380	2850	100	71×28×34
WQ15-40-5.5	15	40	5.5	380	2850	50	79×28×34
WQ25-32-5.5	25	32	5.5	380	2850	50	79×28×34
WQ30-25-5.5	30	25	5.5	380	2850	65	79×28×34
WQ50-18-5.5	50	18	5.5	380	2850	80	79×28×34
WQ70-15-5.5	70	15	5.5	380	2850	100	79×28×34
WQ20-40-7.5	20	40	7.5	380	2850	50	81×33×39
WQ30-32-7.5	30	32	7.5	380	2850	65	81×33×39
WQ45-22-7.5	45	22	7.5	380	2850	80	81×33×39
WQ80-20-7.5	80	20	7.5	380	2850	100	81×33×39
WQ100-15-7.5	100	15	7.5	380	2850	150	81×33×39
WQ20-50-11	20	50	11	380	2850	50	92×33×39
WQ50-40-11	50	40	11	380	2850	65	92×33×39
WQ70-35-11	70	35	11	380	2850	80	92×33×39
WQ100-25-11	100	25	11	380	2850	100	92×33×39
WQ180-11-11	180	11	11	380	2850	150	92×33×39
WQ220-8-11	220	8	11	380	2850	200	92×33×39
WQ20-55-15	20	55	15	380	2850	50	92×33×39
WQ45-50-15	45	50	15	380	2850	65	92×33×39
WQ80-32-15	80	32	15	380	2850	80	92×33×39
WQ120-25-15	120	25	15	380	2850	100	92×33×39
WQ180-15-15	180	15	15	380	2850	150	92×33×39
WQ220-10-15	220	10	15	380	2850	200	92×33×39
WQ100-20-11	100	20	11	380	1450	100	50×55×110
WQ180-11-11	180	11	11	380	1450	150	50×55×110
WQ300-7-11	300	7	11	380	1450	200	50×55×110
WQ100-30-15	100	30	15	380	1450	100	50×55×110
WQ180-15-15	180	15	15	380	1450	150	50×55×110
WQ250-11-15	250	11	15	380	1450	200	50×55×110
WQ100-35-18.5	100	35	18.5	380	1450	100	50×60×115

技术参数/Technical Parameters

产品型号 Model	额定流量 Flow (m³/h)	额定扬程 Lift (m)	功率 Rate power (kw)	电压 Rated voltage (V)	转速 Rotating speed (r/min)	口径 caliber (mm)	包装尺寸 长×宽×高 Package dimensions Length × width × height (cm)
WQ180-20-18.5	180	20	18.5	380	1450	150	50×60×115
WQ250-15-18.5	250	15	18.5	380	1450	200	50×60×115
WQ100-40-22	100	40	22	380	1450	100	50×60×115
WQ200-22-22	200	22	22	380	1450	150	50×60×115
WQ300-16-22	300	16	22	380	1450	200	50×60×115
WQ120-45-30	120	45	30	380	1450	100	/
WQ180-30-30	180	30	30	380	1450	150	/
WQ250-22-30	250	22	30	380	1450	200	/
WQ600-9-30	600	9	30	380	1450	250	/
WQ800-7-30	800	7	30	380	1450	300	/
WQ120-50-37	120	50	37	380	1450	100	/
WQ200-30-37	200	30	37	380	1450	150	/
WQ350-25-37	350	25	37	380	1450	200	/
WQ600-12-37	600	12	37	380	1450	250	/
WQ800-9-37	800	9	37	380	1450	300	/
WQ100-55-45	100	55	45	380	1450	100	/
WQ200-35-45	200	35	45	380	1450	150	/
WQ400-25-45	400	25	45	380	1450	200	/
WQ600-15-45	600	15	45	380	1450	250	/
WQ800-12-45	800	12	45	380	1450	300	/
WQ100-65-55	100	65	55	380	1450	100	/
WQ180-50-55	180	50	55	380	1450	150	/
WQ300-40-55	300	40	55	380	1450	200	/
WQ400-30-55	400	30	55	380	1450	200	/
WQ600-20-55	600	20	55	380	1450	250	/
WQ800-15-55	800	15	55	380	1450	300	/
WQ120-75-75	120	75	75	380	1450	150	/
WQ350-45-75	350	45	75	380	1450	200	/
WQ600-25-75	600	25	75	380	1450	250	/
WQ800-20-75	800	20	75	380	1450	300	/
WQ200-70-90	200	70	90	380	1450	150	/
WQ300-60-90	300	60	90	380	1450	200	/
WQ400-50-90	400	50	90	380	1450	200	/
WQ600-30-90	600	30	90	380	1450	250	/
WQ800-25-90	800	25	90	380	1450	300	/
WQ180-80-110	180	80	110	380	1450	150	/
WQ300-65-110	300	65	110	380	1450	200	/
WQ600-40-110	600	40	110	380	1450	250	/
WQ1000-25-110	1000	25	110	380	1450	300	/
WQ200-90-132	200	90	132	380	1450	150	/
WQ400-75-132	400	75	132	380	1450	200	/
WQ600-50-132	600	50	132	380	1450	250	/
WQ800-36-132	800	36	132	380	1450	300	/

**WQ(D)-S**  
Stainless steel precision casting Sewage Submersible Pump (GB Flange)

**不锈钢精密铸造**  
污水污物潜水电泵(国标法兰)

**产品概述/Product Description**

1. 国标法兰WQ(D)-S不锈钢精密铸造污水污物潜水电泵采用不锈钢精密铸造外壳，具有耐腐蚀，环保型，扬程高，流量大等特点。
  2. 油室采用氟橡胶双面机械密封，外室采用单面氟橡胶机械油封结构，有效地减少因骨架油封与轴之间摩擦而造成的密封进水问题。
  3. 电机采用高温线，F级绝缘，热保护装置，有效地延长泵的使用寿命。
  4. 根据客户的要求，可带搅匀装置，该装置随电机轴旋转产生极强的搅拌力，将污水池内的沉积物拌成悬浮物后排出。也可带切割装置，能将污水中的长纤维，塑料，纸袋，稻草等杂物碎片后排出。
1. GB Flange WQ(D)-S Stainless Steel Precision Casting Sewage Submersible Pumps made of stainless steel precision casting shell . It has the characteristics of corrosion resistant, environmental protection, large flow, high head ,and so on.
  2. Oil chamber adopts fluorine rubber-double face seal and out chamber flow fluorine rubber-single face seal, which is effectively to avoid the water seepage.
  3. Motor adopts high temperature winding with F class insulation, equipped seepage with thermal protection device, making the long service life longer.
  4. According to the customer's request, it can be equipped with a stirring device. The device generates a strong stirring force with the rotation of the motor shaft, and the sediment in the sewage pool is mixed into a suspended matter and discharged. It can also be equipped with a cutting device to discharge long debris, plastic, paper bags, straw and other debris in the sewage.

**使用条件/Conditions Of Use**

1. 以叶轮中心为准，潜入水下深度不得超过5m;
  2. 输送介质温度不高于60°C ;
  3. 输送介质的PH值304(4-10),316(4-13);
  4. 输送介质的运动黏度为 $7 \times 10^{-7} \sim 23 \times 10^{-6} \text{m}^2/\text{S}$
- 产品材料耐腐蚀性能详情请参考P39-40

1. According to the center of the impeller, the max immersion depth is 5m
  2. Max temperature of the conveying is 60°C
  3. The PH value of convey temperature is 304(4-10),316(4-13)
  4. Kinematic viscosity of transport medium is  $7 \times 10^{-7} \sim 23 \times 10^{-6} \text{m}^2/\text{S}$
- Please refer to P39-40 for details of corrosion resistance of product materials.

**型号说明/Model Description**

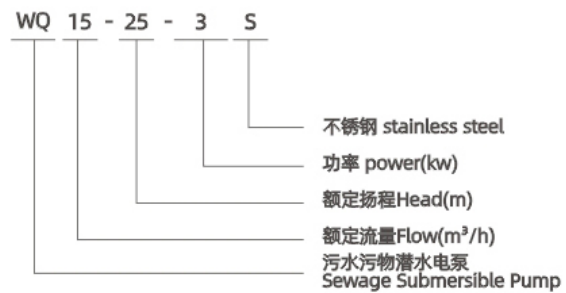

**性能曲线/Performance Curve**

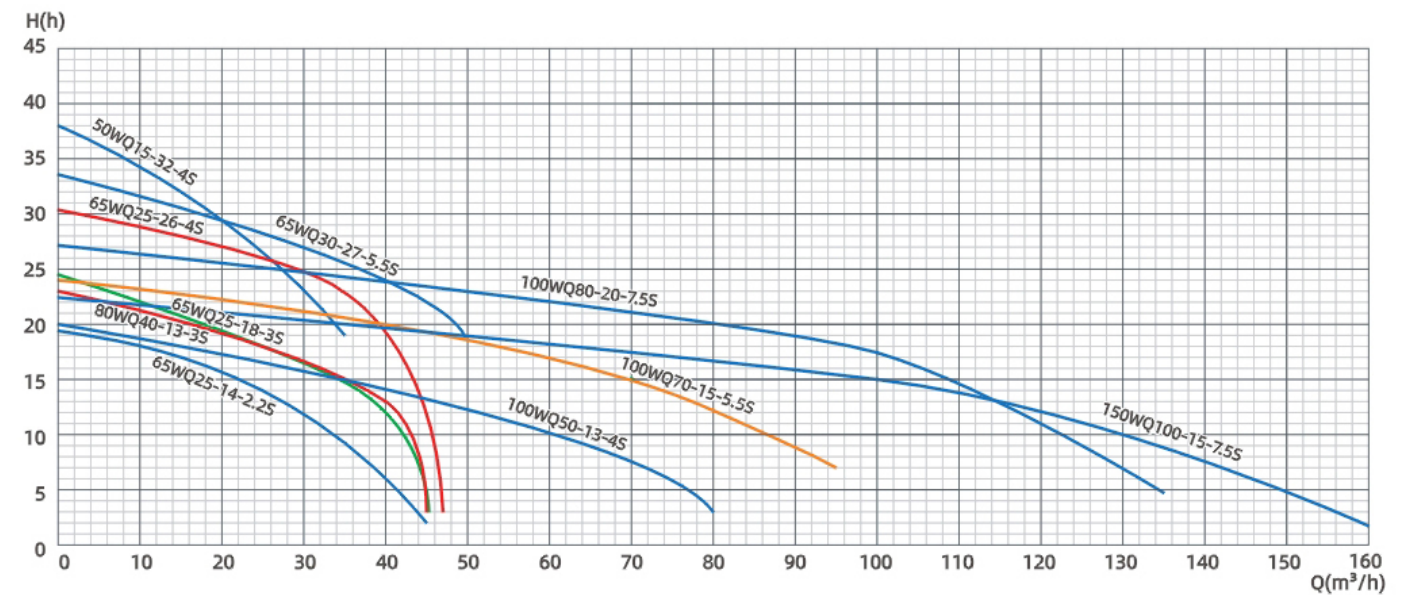
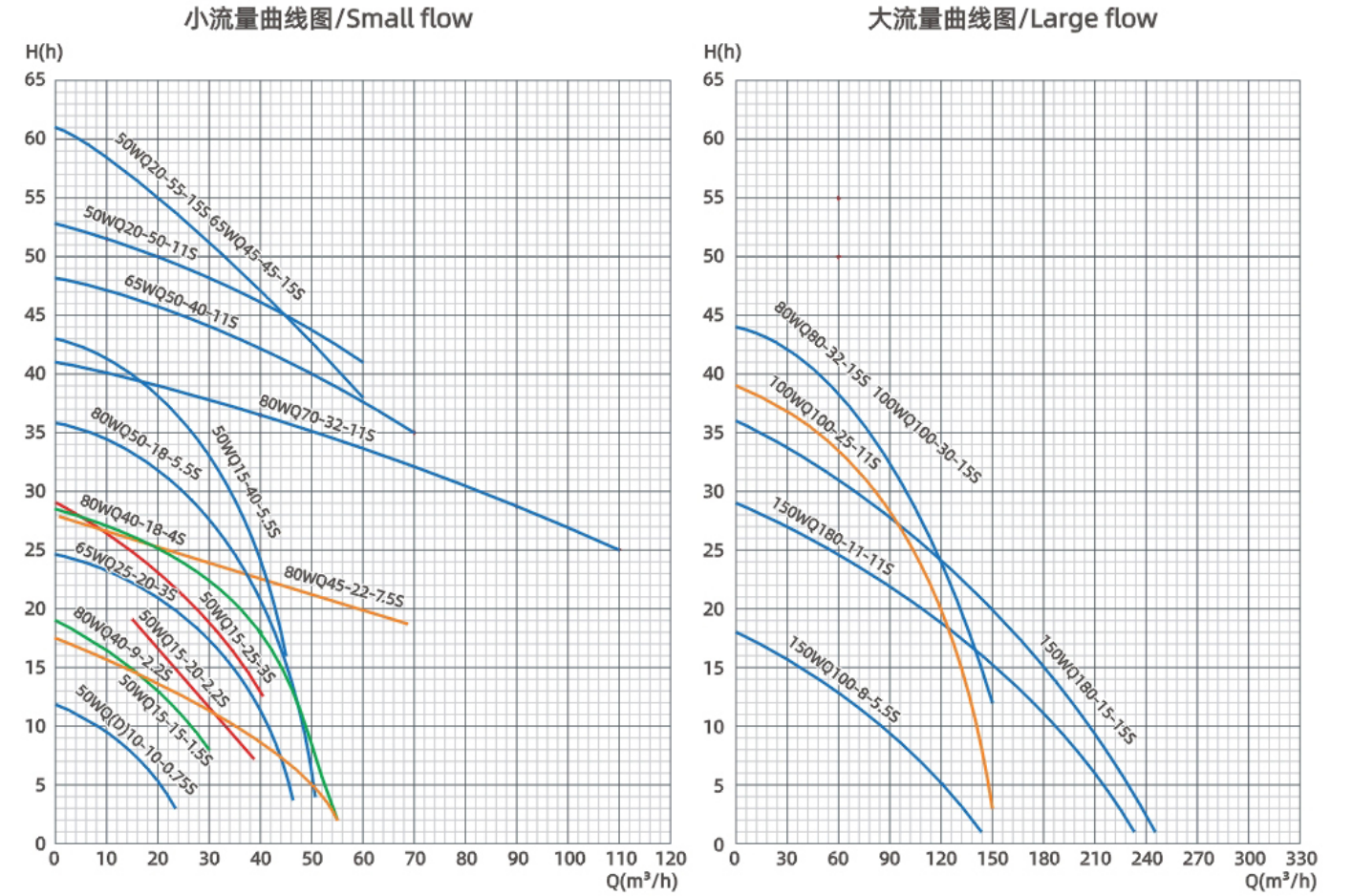

技术参数/Technical Parameters

产品型号 (二级电机型) Model (Two-pole motor type)	额定 流量 Flow (m <sup>3</sup> /h)	额定 扬程 Lift (m)	功率 Rate power (kw)	电压 Rated voltage (V)	转速 Rotating speed (r/min)	口径 caliber (mm)	包装尺寸 长×宽×高 Package dimensions Length × width × height (cm)
WQ(D)10-10-0.75S	10	10	0.75	220/380	2850	50	54×22×25
WQ(D)15-6-0.75S	15	6	0.75	220/380	2850	65	54×22×25
WQ(D)7-15-1.1S	7	15	1.1	220/380	2850	50	58×22×26
WQ(D)20-6-1.1S	20	6	1.1	220/380	2850	65	58×22×26
WQ(D)15-15-1.5S	15	15	1.5	220/380	2850	50	58×22×26
WQ(D)25-7-1.5S	25	7	1.5	220/380	2850	65	58×22×26
WQ(D)15-20-2.2S	15	20	2.2	220/380	2850	50	58×22×26
WQ(D)25-15-2.2S	25	15	2.2	220/380	2850	65	58×22×26
WQ(D)40-9-2.2S	40	9	2.2	220/380	2850	80	58×22×26
WQ(D)50-7-2.2S	50	7	2.2	220/380	2850	100	58×22×26
WQ15-25-3S	15	25	3	380	2850	50	64×24×28
WQ25-20-3S	25	20	3	380	2850	65	64×24×28
WQ40-15-3S	40	15	3	380	2850	80	64×24×28
WQ50-10-3S	50	10	3	380	2850	100	64×24×28
WQ15-32-4S	15	32	4	380	2850	50	71×28×34
WQ25-25-4S	25	25	4	380	2850	65	71×28×34
WQ40-18-4S	40	18	4	380	2850	80	71×28×34
WQ50-15-4S	50	15	4	380	2850	100	71×28×34
WQ15-40-5.5S	15	40	5.5	380	2850	50	79×28×34
WQ30-25-5.5S	30	25	5.5	380	2850	65	79×28×34

技术参数/Technical Parameters

产品型号 (二级电机型) Model (Two-pole motor type)	额定 流量 Flow (m <sup>3</sup> /h)	额定 扬程 Lift (m)	功率 Rate power (kw)	电压 Rated voltage (V)	转速 Rotating speed (r/min)	口径 caliber (mm)	包装尺寸 长×宽×高 Package dimensions Length × width × height (cm)
WQ50-18-5.5S	50	18	5.5	380	2850	80	79×28×34
WQ80-10-5.5S	80	10	5.5	380	2850	100	79×28×34
WQ100-8-5.5S	100	8	5.5	380	2850	150	79×28×34
WQ20-40-7.5S	20	40	7.5	380	2850	50	79×28×34
WQ30-32-7.5S	30	32	7.5	380	2850	65	79×28×34
WQ45-22-7.5S	45	22	7.5	380	2850	80	79×28×34
WQ80-20-7.5S	80	20	7.5	380	2850	100	79×28×34
WQ100-15-7.5S	100	15	7.5	380	2850	150	79×28×34
WQ20-50-11S	20	50	11	380	2850	50	92×33×39
WQ30-50-11S	30	50	11	380	2850	65	92×33×39
WQ45-42-11S	45	42	11	380	2850	80	92×33×39
WQ100-20-11S	100	20	11	380	2850	100	92×33×39
WQ180-11-11S	180	11	11	380	2850	150	92×33×39
WQ220-8-11S	220	8	11	380	2850	200	92×33×39
WQ20-55-15S	20	55	15	380	2850	50	92×33×39
WQ30-60-15S	30	60	15	380	2850	65	92×33×39
WQ45-52-15S	45	52	15	380	2850	80	92×33×39
WQ100-25-15S	100	25	15	380	2850	100	92×33×39
WQ180-15-15S	180	15	15	380	2850	150	92×33×39
WQ220-10-15S	220	10	15	380	2850	200	92×33×39

技术参数/Technical Parameters

产品型号 (四级电机型) Model (Four-pole motor type)	额定流量 Flow (m <sup>3</sup> /h)	额定扬程 Lift (m)	功率 Rate power (kw)	电压 Rated voltage (V)	转速 Rotating speed (r/min)	口径 caliber (mm)	包装尺寸 长×宽×高 Package dimensions Length × width × height (cm)
WQ100-20-11S	100	20	11	380	1450	100	50×55×110
WQ180-11-11S	180	11	11	380	1450	150	50×55×110
WQ250-7-11S	250	7	11	380	1450	200	50×55×110
WQ100-30-15S	100	30	15	380	1450	100	50×55×110
WQ180-15-15S	180	15	15	380	1450	150	50×55×110
WQ250-11-15S	250	11	15	380	1450	200	50×55×110
WQ100-30-18.5S	100	30	18.5	380	1450	100	50×60×115
WQ180-20-18.5S	180	20	18.5	380	1450	150	50×60×115
WQ250-15-18.5S	250	15	18.5	380	1450	200	50×60×115
WQ100-35-22S	100	35	22	380	1450	100	50×60×115
WQ180-25-22S	180	25	22	380	1450	150	50×60×115
WQ250-20-22S	250	20	22	380	1450	200	50×60×115
WQ120-45-30S	120	45	30	380	1450	100	/
WQ180-30-30S	180	30	30	380	1450	150	/
WQ250-22-30S	250	22	30	380	1450	200	/
WQ600-9-30S	600	9	30	380	1450	250	/
WQ800-7-30S	800	7	30	380	1450	300	/
WQ120-50-37S	120	50	37	380	1450	100	/
WQ200-30-37S	200	30	37	380	1450	150	/
WQ350-25-37S	350	25	37	380	1450	200	/
WQ600-12-37S	600	12	37	380	1450	250	/
WQ800-9-37S	800	9	37	380	1450	300	/
WQ1000-6-37S	1000	6	37	380	1450	350	/
WQ100-55-45S	100	55	45	380	1450	100	/
WQ200-35-45S	200	35	45	380	1450	200	/
WQ400-25-45S	400	25	45	380	1450	400	/
WQ600-15-45S	600	15	45	380	1450	600	/
WQ800-12-45S	800	12	45	380	1450	800	/
WQ1000-8-45S	1000	8	45	380	1450	1000	/

技术参数/Technical Parameters

产品型号 (四级电机型) Model (Four-pole motor type)	额定流量 Flow (m <sup>3</sup> /h)	额定扬程 Lift (m)	功率 Rate power (kw)	电压 Rated voltage (V)	转速 Rotating speed (r/min)	口径 caliber (mm)	包装尺寸 长×宽×高 Package dimensions Length × width × height (cm)
WQ100-65-55S	100	65	55	380	1450	100	/
WQ180-50-55S	180	50	55	380	1450	150	/
WQ300-40-55S	300	40	55	380	1450	200	/
WQ400-30-55S	400	30	55	380	1450	200	/
WQ600-20-55S	600	20	55	380	1450	250	/
WQ800-15-55S	800	15	55	380	1450	300	/
WQ1000-10-55S	1000	10	55	380	1450	350	/
WQ120-75-75S	120	75	75	380	1450	150	/
WQ350-45-75S	350	45	75	380	1450	200	/
WQ600-25-75S	600	25	75	380	1450	250	/
WQ800-20-75S	800	20	75	380	1450	300	/
WQ1000-15-75S	1000	15	75	380	1450	350	/
WQ200-70-90S	200	70	90	380	1450	150	/
WQ300-60-90S	300	60	90	380	1450	200	/
WQ400-50-90S	400	50	90	380	1450	200	/
WQ600-30-90S	600	30	90	380	1450	250	/
WQ800-25-90S	800	25	90	380	1450	300	/
WQ1000-18-90S	1000	18	90	380	1450	350	/
WQ180-80-110S	180	80	110	380	1450	150	/
WQ300-65-110S	300	65	110	380	1450	200	/
WQ600-40-110S	600	40	110	380	1450	250	/
WQ1000-25-110S	1000	25	110	380	1450	300	/
WQ1300-20-110S	1300	20	110	380	1450	350	/
WQ200-90-132S	200	90	132	380	1450	150	/
WQ400-75-132S	400	75	132	380	1450	200	/
WQ600-50-132S	600	50	132	380	1450	250	/
WQ800-36-132S	800	36	132	380	1450	300	/
WQ1100-28-132S	1100	28	132	380	1450	350	/



**BWQ**  
**Flameproof submersible sewage pump**  
隔爆型潜水排污泵

**产品概述/Product Description**

BWQ系列工厂用隔爆型潜水排污泵是我公司最新研制的新型防爆产品,防爆性能按GB3836.1-2010《爆炸性环境 第1部分:设备通过要求》和GB3836.2-2010《爆炸性环境 第2部分:由隔热外壳“d”保护的设 备》标准要求制成隔爆型,防爆标志:ExdII BT4。整个系列产品均取得防爆合格证,型号齐全,选型方便。

BWQ series flame-proof submersible sewage pump is a latest type of flame-proof products developed by our company, flame-proof performance is in accordance with GB3836.1-2010 Explosive Environment part I: General Requirements for Equipment and GB3836.2-2010 Explosive Environment part II: Flame-proof Shell "d" Protection Equipment made of flame proof standards, Explosion-proof mark: ExdII BT4. The whole series products have acquired explosion proof certification, type completed and convenient selection

**应用范围/Application Range**

BWQ产品用于工厂IIB级,温度组别为T1-T4组的可燃气体或蒸汽与空气形成的爆炸性混合物场所的污水排放。适用于煤化工、石油化工、市政工程、城市工业、医院、宾馆、住宅小区等场所。

The product is used for swage discharge in the IIB factory where the temperature group is T1-T4 of combustible gas and explosible mixture of steam and air. It is suitable for coal chemical industry, petrochemical industry, municipal engineering, urban engineering, hospitals, hotels, residential areas and other places.

**型号说明/Model Description**

B WQ 10 - 10 - 0.75 S/JY/QG

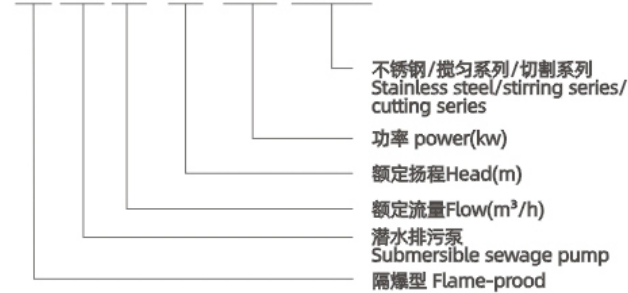

**使用条件/Conditions Of Use**

- 1、符合产品防爆标志的有隔爆要求的场合
- 2、电源电压: 电压380V、660V、三相, 50Hz
- 3、输送介质温度: 0-40°C(超过此温度另有热水泵型)
- 4、输送介质PH值: 5-9
- 5、介质重量: ≤1100Kg/m³
- 6、最大潜水深度: 20m

产品材料耐腐蚀性能详情请参考P39-40

1. Meeting the requirements of explosion-proof in accordance with the product flame-proof mark.
  2. Supply power: 380v, 660v, 3 phase, 50Hz
  3. Medium temperature: 0-40°C (above the temperature, there will be other hot water pump model)
  4. Medium PH value: 5-9
  5. Medium weight: ≤1100Kg/m³
  6. Maxium depth: 20m
- Please refer to P39-40 for details of corrosion resistance of product materials.

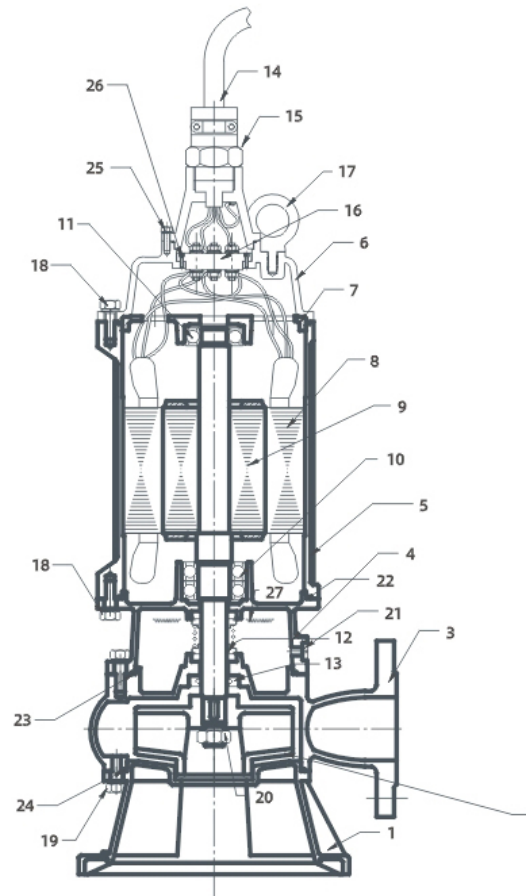

序号 NO.	名称 name	数量 Quantity	材质 Material
1	进水口底座	1	304
2	叶轮	1	304
3	50WQ泵体	1	304
4	下端盖	1	304
5	机座	1	304
6	上端盖	1	304
7	轴承盖板	1	304
8	带线定子	1	组合件
9	带轴转子	1	组合件
10	深沟球轴承	2	
11	深沟球轴承	1	
12	机械密封	1	组合件
13	骨架油封	1	氟橡胶
14	电缆线	1	组合件
15	防爆电缆压盖组	1+1	304
16	防爆接线柱	1	304
17	吊环螺栓	2	304
18	内六角螺丝+弹垫	18	304
19	内六角螺丝+弹垫	4	304
20	螺母	1	304
21	油孔螺丝	1	304
22	O型橡胶圈	2	氟橡胶
23	O型橡胶圈	1	氟橡胶
24	O型橡胶圈	1	氟橡胶
25	外六角螺丝+弹垫	3	304
26	内六角螺丝	3	304
27	机械油	1	

**性能曲线/Performance Curve**

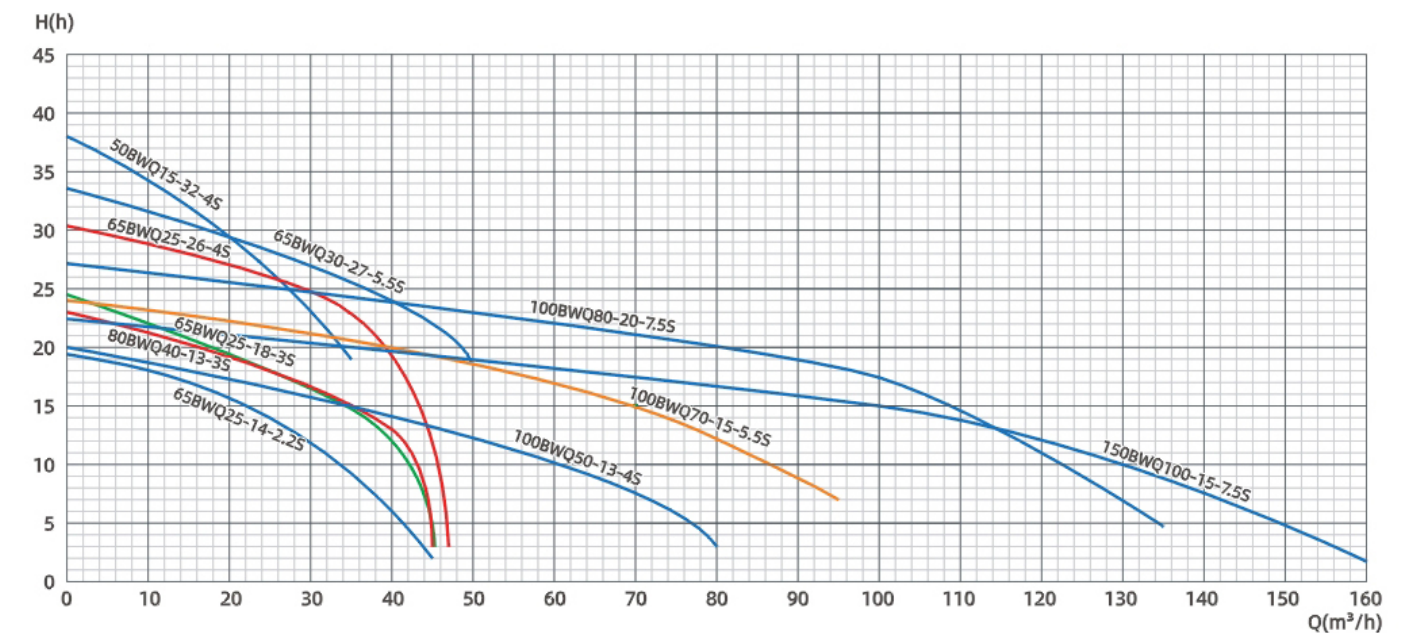

技术参数/Technical Parameters

产品型号 Model	额定流量 Flow (m³/h)	额定扬程 Lift (m)	功率 Rate power (kw)	电压 Rated voltage (V)	口径 caliber (mm)	转速 Rotating speed (r/min)
BWQ10-10-0.75S	10	10	0.75	380	50	2850
BWQ15-6-0.75S	15	6	0.75	380	65	2850
BWQ7-15-1.1S	7	15	1.1	380	50	2850
BWQ20-6-1.1S	20	6	1.1	380	65	2850
BWQ15-15-1.5S	15	15	1.5	380	50	2850
BWQ25-7-1.5S	25	7	1.5	380	65	2850
BWQ15-20-2.2S	15	20	2.2	380	50	2850
BWQ25-15-2.2S	25	15	2.2	380	65	2850
BWQ40-9-2.2S	40	9	2.2	380	80	2850
BWQ15-25-3S	15	25	3	380	50	2850
BWQ25-20-3S	25	20	3	380	65	2850
BWQ40-15-3S	40	15	3	380	80	2850
BWQ15-32-4S	15	32	4	380	50	2850
BWQ25-25-4S	25	25	4	380	65	2850
BWQ40-18-4S	40	18	4	380	80	2850
BWQ50-15-4S	50	15	4	380	100	2850
BWQ15-40-5.5S	15	40	5.5	380	50	2850
BWQ25-32-5.5S	25	32	5.5	380	50	2850
BWQ30-25-5.5S	30	25	5.5	380	65	2850
BWQ50-18-5.5S	50	18	5.5	380	80	2850
BWQ70-15-5.5S	70	15	5.5	380	100	2850
BWQ100-8-5.5S	100	8	5.5	380	150	2850
BWQ20-40-7.5S	20	40	7.5	380	50	2850
BWQ30-32-7.5S	30	32	7.5	380	65	2850
BWQ45-22-7.5S	45	22	7.5	380	80	2850
BWQ80-20-7.5S	80	20	7.5	380	100	2850
BWQ100-15-7.5S	100	15	7.5	380	150	2850
BWQ20-50-11S	20	50	11	380	50	2850
BWQ50-40-11S	50	40	11	380	65	2850
BWQ70-30-11S	70	30	11	380	80	2850
BWQ100-25-11S	100	25	11	380	100	2850
BWQ180-11-11S	180	11	11	380	150	2850
BWQ220-8-11S	220	8	11	380	200	2850
BWQ20-55-15S	20	55	15	380	50	2850
BWQ45-50-15S	45	50	15	380	65	2850
BWQ80-32-15S	80	32	15	380	80	2850
BWQ120-25-15S	120	25	15	380	100	2850
BWQ180-15-15S	180	15	15	380	150	2850
BWQ220-10-15S	220	10	15	380	200	2850

技术参数/Technical Parameters

产品型号 (搅匀系列) Model (stirring series)	额定流量 Flow (m³/h)	额定扬程 Lift (m)	功率 Rate power (kw)	电压 Rated voltage (V)	毛重 Gross weight (kg)	转速 Rotating speed (r/min)
BWQ10-10-0.75JY	10	10	0.75	380	50	2850
BWQ15-6-0.75JY	15	6	0.75	380	65	2850
BWQ7-15-1.1JY	7	15	1.1	380	50	2850
BWQ20-6-1.1JY	20	6	1.1	380	65	2850
BWQ15-15-1.5JY	15	15	1.5	380	50	2850
BWQ25-7-1.5JY	25	7	1.5	380	65	2850
BWQ15-20-2.2JY	15	20	2.2	380	50	2850
BWQ25-15-2.2JY	25	15	2.2	380	65	2850
BWQ40-9-2.2JY	40	9	2.2	380	80	2850
BWQ15-25-3JY	15	25	3	380	50	2850
BWQ25-20-3JY	25	20	3	380	65	2850
BWQ40-15-3JY	40	15	3	380	80	2850
BWQ15-32-4JY	15	32	4	380	50	2850
BWQ25-25-4JY	25	25	4	380	65	2850
BWQ40-18-4JY	40	18	4	380	80	2850
BWQ50-15-4JY	50	15	4	380	100	2850
BWQ15-40-5.5JY	15	40	5.5	380	50	2850
BWQ25-32-5.5JY	25	32	5.5	380	50	2850
BWQ30-25-5.5JY	30	25	5.5	380	65	2850
BWQ50-18-5.5JY	50	18	5.5	380	80	2850
BWQ70-15-5.5JY	70	15	5.5	380	100	2850
BWQ100-8-5.5JY	100	8	5.5	380	150	2850
BWQ20-40-7.5JY	20	40	7.5	380	50	2850
BWQ30-32-7.5JY	30	32	7.5	380	65	2850
BWQ45-22-7.5JY	45	22	7.5	380	80	2850
BWQ80-20-7.5JY	80	20	7.5	380	100	2850
BWQ100-15-7.5JY	100	15	7.5	380	150	2850
BWQ20-50-11JY	20	50	11	380	50	2850
BWQ50-40-11JY	50	40	11	380	65	2850
BWQ70-30-11JY	70	30	11	380	80	2850
BWQ100-25-11JY	100	25	11	380	100	2850
BWQ180-11-11JY	180	11	11	380	150	2850
BWQ220-8-11JY	220	8	11	380	200	2850
BWQ20-55-15JY	20	55	15	380	50	2850
BWQ45-50-15JY	45	50	15	380	65	2850
BWQ80-32-15JY	80	32	15	380	80	2850
BWQ120-25-15JY	120	25	15	380	100	2850
BWQ180-15-15JY	180	15	15	380	150	2850
BWQ220-10-15JY	220	10	15	380	200	2850

技术参数/Technical Parameters

产品型号 (切割系列) Model (cutting series)	额定流量 Flow (m <sup>3</sup> /h)	额定扬程 Lift (m)	功率 Rate power (kw)	电压 Rated voltage (V)	口径 caliber (mm)	转速 Rotating speed (r/min)
BWQ10-10-0.75QG	10	10	0.75	380	50	2850
BWQ10-13-1.1QG	10	13	1.1	380	50	2850
BWQ15-13-1.5QG	15	13	1.5	380	50	2850
BWQ25-7-1.5QG	25	7	1.5	380	65	2850
BWQ15-18-2.2QG	15	18	2.2	380	50	2850
BWQ25-13-2.2QG	25	13	2.2	380	65	2850
BWQ35-9-2.2QG	35	9	2.2	380	80	2850
BWQ15-25-3QG	15	25	3	380	50	2850
BWQ25-18-3QG	25	18	3	380	65	2850
BWQ35-13-3QG	35	13	3	380	80	2850
BWQ15-32-4QG	15	32	4	380	50	2850
BWQ40-15-4QG	40	15	4	380	65	2850
BWQ50-12-4QG	50	12	4	380	80	2850
BWQ70-9-4QG	70	9	4	380	100	2850
BWQ18-35-5.5QG	18	35	5.5	380	50	2850
BWQ30-25-5.5QG	30	25	5.5	380	65	2850
BWQ50-16-5.5QG	50	16	5.5	380	80	2850
BWQ70-12-5.5QG	70	12	5.5	380	100	2850
BWQ20-40-7.5QG	20	40	7.5	380	50	2850
BWQ30-32-7.5QG	30	32	7.5	380	65	2850
BWQ45-22-7.5QG	45	22	7.5	380	80	2850
BWQ70-17-7.5QG	70	17	7.5	380	100	2850
BWQ140-10-7.5QG	140	10	7.5	380	150	2850

**JYWQ(D)-S**  
Stainless steel precision casting  
Automatic stirring sewage pump (GB Flange)

**不锈钢精密铸造**  
自动搅匀排污泵(国标法兰)

产品概述/Product Description

- JYWQ(D)-S系列不锈钢精密铸造污水物潜水电泵采用独特的单、双流道式叶轮结构,提高了污物的通过能力,根据产品型号能通过泵口径5倍的纤维,与直径约为泵出口口径50%的固体颗粒。
- 采用氟橡胶双端面机封,氟橡胶径向O型圈密封,有效对环境恶劣的液体进行密封保护作用。
- 采用精密铸造泵壳,重量轻、耐腐蚀、节能型、外形美观、检修方便、无需建泵房,潜入水中即可工作,减少工程价。
- 水泵内安装过热与电流保护器,防止电机过载发热。

特点:利用泵自身出水压力,搅匀污水池内沉淀污泥,真正达到彻底排出污水池沉淀物的目的。

- JYWQ(D)-S series stainless steel precision casting sewage sewage submersible pump adopts unique single and double -flow impeller structure, which improves the ability of dirt to pass. According to the product model, it can pass the fiber 5 times of pump diameter, and solid particles half the diameter outlet of the pump.
- Using fluorine rubber seal double end face and fluorine rubber o-rings radial seal, effectively prevent contaminated water infiltration on conditions of liquid seal protection.
- It adopts precision casting pump casing, which is light in weight, corrosion-resistant energy-saving, beautiful in appearance, convenient in maintenance, no need to build pump room, enabling it to work in submersible water, and reduce engineering price.
- Install an overheating and current protector in the electric pump to prevent the motor from overloading and heating.

Features: The pump's own water pressure is used to mix the sediment sludge in the sewage pool to achieve the purpose of discharging the sediment from the sewage pool.

使用条件/Conditions Of Use

- 以叶轮中心为准,潜入水下深度不得超过5m;
- 输送介质温度不高于60°C;
- 输送介质的运动黏度为 $7 \times 10^{-7} \sim 23 \times 10^{-6} \text{m}^2/\text{s}$

产品材料耐腐蚀性能详情请参考P39-40

- According to the center of the impeller, the max immersion depth is 5m
- Max temperature of the conveying is 60°C
- Kinematic viscosity of transport medium is  $7 \times 10^{-7} \sim 23 \times 10^{-6} \text{m}^2/\text{s}$

Please refer to P39-40 for details of corrosion resistance of product materials.

型号说明/Model Description

JYWQ 15 - 10 - 1.1 S

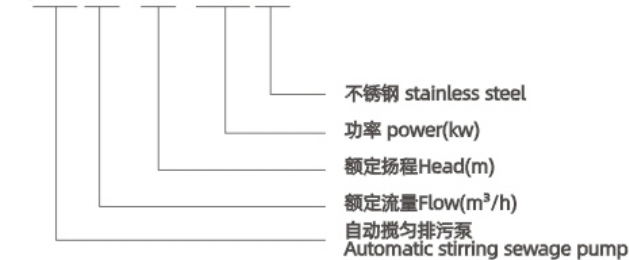

性能曲线/Performance Curve

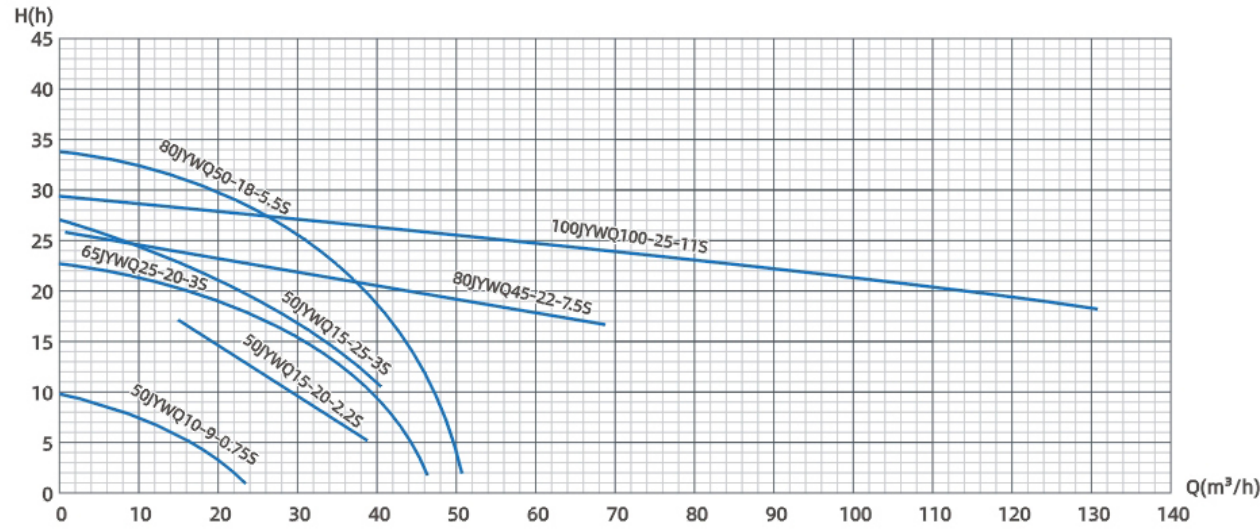

技术参数/Technical Parameters

产品型号 Model	额定流量 Flow (m³/h)	额定扬程 Lift (m)	功率 Rate power (kw)	电压 Rated voltage (V)	转速 Rotating speed (r/min)	口径 caliber (mm)	包装尺寸 长×宽×高 Package dimensions Length × width × height (cm)
JYWQD10-9-0.75S	10	9	0.75	220	2850	50	54×22×25
JYWQD15-6-0.75S	15	6	0.75	220	2850	65	54×22×25
JYWQD7-14-1.1S	7	14	1.1	220	2850	50	58×22×26
JYWQD20-6-1.1S	20	6	1.1	220	2850	65	58×22×26
JYWQ10-10-0.75S	10	10	0.75	380	2850	50	58×22×26
JYWQ15-6-0.75S	15	6	0.75	380	2850	65	58×22×26
JYWQ15-10-1.1S	15	10	1.1	380	2850	50	58×22×26
JYWQ20-6-1.1S	20	6	1.1	380	2850	65	58×22×26
JYWQD15-14-1.5S	15	14	1.5	220	2850	50	58×22×26
JYWQD25-7-1.5S	25	7	1.5	220	2850	65	58×22×26
JYWQ15-12-1.5S	15	12	1.5	380	2850	50	58×22×26
JYWQ25-7-1.5S	25	7	1.5	380	2850	65	58×22×26
JYWQD15-18-2.2S	15	18	2.2	220	2850	50	58×22×26
JYWQD25-13-2.2S	25	13	2.2	220	2850	65	58×22×26
JYWQD40-8-2.2S	40	8	2.2	220	2850	80	58×22×26
JYWQD50-7-2.2S	50	7	2.2	220	2850	100	58×22×26
JYWQ15-20-2.2S	15	20	2.2	380	2850	50	58×22×26
JYWQ25-15-2.2S	25	15	2.2	380	2850	65	58×22×26
JYWQ40-9-2.2S	40	9	2.2	380	2850	80	58×22×26
JYWQ50-7-2.2S	50	7	2.2	380	2850	100	58×22×26

技术参数/Technical Parameters

产品型号 Model	额定流量 Flow (m³/h)	额定扬程 Lift (m)	功率 Rate power (kw)	电压 Rated voltage (V)	转速 Rotating speed (r/min)	口径 caliber (mm)	包装尺寸 长×宽×高 Package dimensions Length × width × height (cm)
JYWQ15-25-3S	15	25	3	380	2850	50	64×24×28
JYWQ25-20-3S	25	20	3	380	2850	65	64×24×28
JYWQ40-15-3S	40	15	3	380	2850	80	64×24×28
JYWQ50-10-3S	50	10	3	380	2850	100	64×24×28
JYWQ15-32-4S	15	32	4	380	2850	50	71×28×34
JYWQ25-25-4S	25	25	4	380	2850	65	71×28×34
JYWQ40-18-4S	40	18	4	380	2850	80	71×28×34
JYWQ50-15-4S	50	15	4	380	2850	100	71×28×34
JYWQ15-38-5.5S	15	38	5.5	380	2850	50	79×28×34
JYWQ30-25-5.5S	30	25	5.5	380	2850	65	79×28×34
JYWQ50-18-5.5S	50	18	5.5	380	2850	80	79×28×34
JYWQ80-10-5.5S	80	10	5.5	380	2850	100	79×28×34
JYWQ100-7-5.5S	100	7	5.5	380	2850	150	79×28×34
JYWQ20-40-7.5S	20	40	7.5	380	2850	50	79×28×34
JYWQ30-32-7.5S	30	32	7.5	380	2850	65	79×28×34
JYWQ45-22-7.5S	45	22	7.5	380	2850	80	79×28×34
JYWQ80-15-7.5S	80	15	7.5	380	2850	100	79×28×34
JYWQ100-10-7.5S	100	10	7.5	380	2850	150	79×28×34
JYWQ20-50-11S	20	50	11	380	2850	50	92×33×39
JYWQ50-40-11S	50	40	11	380	2850	65	92×33×39
JYWQ70-30-11S	70	30	11	380	2850	80	92×33×39
JYWQ100-25-11S	100	25	11	380	2850	100	92×33×39
JYWQ180-11-11S	180	11	11	380	2850	150	92×33×39
JYWQ220-8-11S	220	8	11	380	2850	200	92×33×39
JYWQ20-55-15S	20	55	15	380	2850	50	92×33×39
JYWQ45-50-15S	45	50	15	380	2850	65	92×33×39
JYWQ80-32-15S	80	32	15	380	2850	80	92×33×39
JYWQ120-25-15S	120	25	15	380	2850	100	92×33×39
JYWQ180-15-15S	180	15	15	380	2850	150	92×33×39
JYWQ220-10-15S	220	10	15	380	2850	200	92×33×39

技术参数/Technical Parameters

产品型号 Model	额定流量 Flow (m³/h)	额定扬程 Lift (m)	功率 Rate power (kw)	电压 Rated voltage (V)	转速 Rotating speed (r/min)	口径 caliber (mm)	包装尺寸 长×宽×高 Package dimensions Length × width × height (cm)
JYWQ100-20-11S	100	20	11	380	1450	100	50×55×110
JYWQ180-11-11S	180	11	11	380	1450	150	50×55×110
JYWQ300-7-11S	300	7	11	380	1450	200	50×55×110
JYWQ100-30-15S	100	30	15	380	1450	100	50×55×110
JYWQ180-15-15S	180	15	15	380	1450	150	50×55×110
JYWQ250-11-15S	250	11	15	380	1450	200	50×55×110
JYWQ100-35-18.5S	100	35	18.5	380	1450	100	50×60×115
JYWQ180-20-18.5S	180	20	18.5	380	1450	150	50×60×115
JYWQ250-15-18.5S	250	15	18.5	380	1450	200	50×60×115
JYWQ100-40-22S	100	40	22	380	1450	100	50×60×115
JYWQ200-22-22S	200	22	22	380	1450	150	50×60×115
JYWQ300-16-22S	300	16	22	380	1450	200	50×60×115
JYWQ120-45-30S	120	45	30	380	1450	100	/
JYWQ180-30-30S	180	30	30	380	1450	150	/
JYWQ250-22-30S	250	22	30	380	1450	200	/
JYWQ600-9-30S	600	9	30	380	1450	250	/
JYWQ800-7-30S	800	7	30	380	1450	300	/
JYWQ120-50-37S	120	50	37	380	1450	100	/
JYWQ200-30-37S	200	30	37	380	1450	150	/
JYWQ350-25-37S	350	25	37	380	1450	200	/
JYWQ600-12-37S	600	12	37	380	1450	250	/
JYWQ800-9-37S	800	9	37	380	1450	300	/
JYWQ1000-6-37S	1000	6	37	380	1450	350	/
JYWQ100-55-45S	100	55	45	380	1450	100	/
JYWQ200-35-45S	200	35	45	380	1450	150	/
JYWQ400-25-45S	400	25	45	380	1450	200	/
JYWQ600-15-45S	600	15	45	380	1450	250	/
JYWQ800-12-45S	800	12	45	380	1450	300	/
JYWQ1000-8-45S	1000	8	45	380	1450	350	/

技术参数/Technical Parameters

产品型号 Model	额定流量 Flow (m³/h)	额定扬程 Lift (m)	功率 Rate power (kw)	电压 Rated voltage (V)	转速 Rotating speed (r/min)	口径 caliber (mm)	包装尺寸 长×宽×高 Package dimensions Length × width × height (cm)
JYWQ100-65-55S	100	65	55	380	1450	100	/
JYWQ180-50-55S	180	50	55	380	1450	150	/
JYWQ300-40-55S	300	40	55	380	1450	200	/
JYWQ400-30-55S	400	30	55	380	1450	200	/
JYWQ600-20-55S	600	20	55	380	1450	250	/
JYWQ800-15-55S	800	15	55	380	1450	300	/
JYWQ1000-10-55S	1000	10	55	380	1450	350	/
JYWQ120-75-75S	120	75	75	380	1450	150	/
JYWQ350-45-75S	350	45	75	380	1450	200	/
JYWQ600-25-75S	600	25	75	380	1450	250	/
JYWQ800-20-75S	800	20	75	380	1450	300	/
JYWQ1000-15-75S	1000	15	75	380	1450	350	/
JYWQ200-70-90S	200	70	90	380	1450	150	/
JYWQ300-60-90S	300	60	90	380	1450	200	/
JYWQ400-50-90S	400	50	90	380	1450	200	/
JYWQ600-30-90S	600	30	90	380	1450	250	/
JYWQ800-25-90S	800	25	90	380	1450	300	/
JYWQ1000-18-90S	1000	18	90	380	1450	350	/
JYWQ180-80-110S	180	80	110	380	1450	150	/
JYWQ300-65-110S	300	65	110	380	1450	200	/
JYWQ600-40-110S	600	40	110	380	1450	250	/
JYWQ1000-25-110S	1000	25	110	380	1450	300	/
JYWQ1300-20-110S	1300	20	110	380	1450	350	/
JYWQ200-90-132S	200	90	132	380	1450	150	/
JYWQ400-75-132S	400	75	132	380	1450	200	/
JYWQ600-50-132S	600	50	132	380	1450	250	/
JYWQ800-36-132S	800	36	132	380	1450	300	/
JYWQ1100-28-132S	1100	28	132	380	1450	350	/

## WQ(D)-SQG

Stainless Steel Precision Casting Sewage Cutting Sewage Pump (GB Flange)

不锈钢精密铸造  
切割式污水泵(国标法兰)

### 产品概述/Product Description

WQ(D)-SQG带切割装置潜水排污泵具有排污通过能力特别强,带切割性能好,能将污水中的长纤维、塑料、纸、带、布条、稻草、绳子等杂质切碎后排出,采用最先进的方法,设计成最合理的水力特性,使电机可以全扬程运行,优良的干式电机和水泵的最佳组合。电机采用高质量的碳化硅氟橡胶机。

- 1.双端面机械密封和骨架油封组部位,不得超过电动机高度的1/2,抽送污物温度不超过40°C。该系列污水污物潜水排污泵主要用于排送生活废水、污水、人粪尿及含有短纤维纸屑、木屑、淀粉、泥沙、矿石粒等固体悬浮物和非腐蚀性介质,被抽送液体温度不超过40°C,密度不大于1200kg/m<sup>3</sup>,PH值5~9。该排污泵采用双端面机械密封和开式叶轮。
- 2.20铬镍钼材质的合金刀盘和叶轮,耐磨损、不堵塞、不缠绕、具有体积小、结构紧凑、携带方便等优点。

WQ(D)-SQG belt cutting device submersible sewage pump has strong discharge capacity and good cutting performance. It can cut off long fibers, plastic, paper, belt, cloth strip, straw, rope and other impurities in sewage. The most advanced method is adopted to design the most reasonable hydraulic characteristics, so that the electric pump can run the best combination of dry motor and water pump with full head. The electric pump uses a high quality silicon carbide fluoro rubber machine.

1. The surface of the double- end mechanical seal and the skeleton oil seal shall not exceed 1/2 of the height of the motor, and the temperature of the pumped dirt shall not exceed 40°C. The series of sewage and sewage submersible sewage pumps are mainly used for discharging domestic wastewater, sewage, human excrement and solid suspended solids and non-corrosive media containing short fiber paper scraps, wood chips, starch, sediment, ore particles, and pumped liquid. The temperature does not exceed 40°C, the density is not more than 1200 kg/m<sup>3</sup>, the PH value is 5~ 9. The sewage pump adopts double mechanical seal and open impeller
- 2.20 CrNiMo alloy cutter disc and impeller are wear-resistant, non-blocking, non-wound, small in size, compact in structure and convenient to carry.

### 应用范围/Application Range

WQ(D)-SQG带切割装置潜水排污泵主要用于工程污水,生活污水。

- (1)用于建筑工地、工程基础施工、市政设施、自来水厂。
- (2)各种高楼大厦的地下室、人防坑洞、地铁等地下层污水排放。
- (3)中小型企业污水处理及循环水输送。
- (4)食品、造纸、酿造、钢铁及有色金属、制革、纺织、制药、水泥厂等厂矿企业的渣浆液抽送。
- (5)养鸡场、养猪场、各种养殖业,鱼池作抽水清塘,化粪池等各种场合的人畜粪尿抽送等作用。

产品材料耐腐蚀性能详情请参考P39-40

WQ(D)-SQG belt cutting device submersible sewage pump is mainly used for engineering sewage, domestic sewage such as:

- (1) Used in construction sites, engineering foundation construction, municipal facilities, and waterworks.
- (2) Subsurface sewage discharge in basements, civil air defense pits, subways, etc. of various high-rise buildings
- (3) Sewage treatment and circulating water transportation for small and medium-sized enterprises.
- (4) Slurry slurry pumping from factories and mines such as food, paper, brewing, steel and non-ferrous metals, leather, textile, pharmaceutical, and cement plants.
- (5) Chicken farms, pig farms, various breeding industries, fishponds for pumping clear ponds, septic tanks, etc. Please refer to P39-40 for details of corrosion resistance of product materials.

### 型号说明/Model Description

50 WQ 10 - 10 - 0.75 S QG

- 带切割装置 Belt cutting device
- 不锈钢 stainless steel
- 功率 Power(kw)
- 额定扬程 Head(m)
- 额定流量 Flow(m<sup>3</sup>/h)
- 污水污物潜水电泵 Sewage Submersible Pump
- 口径 Outlet (mm)



### 性能曲线/Performance Curve

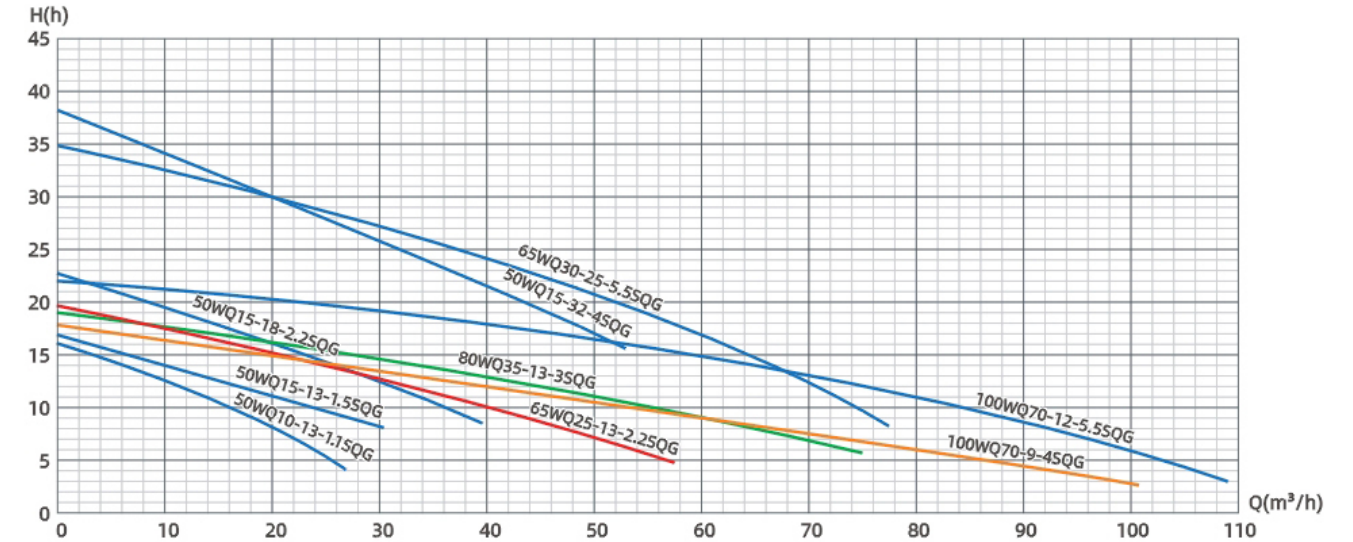

### 技术参数/Technical Parameters

产品型号 Model	额定流量 Flow (m <sup>3</sup> /h)	额定扬程 Lift (m)	功率 Rate power (kw)	电压 Rated voltage (V)	转速 Rotating speed (r/min)	口径 caliber (mm)	包装尺寸 长×宽×高 Package dimensions Length × width × height (cm)
WQ(D)10-10-0.75SQG	10	10	0.75	220/380	2850	50	54×22×25
WQ(D)10-13-1.1SQG	10	13	1.1	220/380	2850	50	58×22×26
WQ(D)15-13-1.5SQG	15	13	1.5	220/380	2850	50	58×22×26
WQ(D)25-7-1.5SQG	25	7	1.5	220/380	2850	65	58×22×26
WQ(D)15-18-2.2SQG	15	18	2.2	220/380	2850	50	58×22×26
WQ(D)25-13-2.2SQG	25	13	2.2	220/380	2850	65	58×22×26
WQ(D)35-9-2.2SQG	35	9	2.2	220/380	2850	80	58×22×26
WQ15-25-3SQG	15	25	3	380	2850	50	64×24×28
WQ25-18-3SQG	25	18	3	380	2850	65	64×24×28
WQ35-13-3SQG	35	13	3	380	2850	80	64×24×28
WQ15-32-4SQG	15	32	4	380	2850	50	71×28×34
WQ40-15-4SQG	40	15	4	380	2850	65	71×28×34
WQ50-12-4SQG	50	12	4	380	2850	80	71×28×34
WQ70-9-4SQG	70	9	4	380	2850	100	71×28×34
WQ18-35-5.5SQG	18	35	5.5	380	2850	50	79×28×34
WQ30-25-5.5SQG	30	25	5.5	380	2850	65	79×28×34
WQ50-16-5.5SQG	50	16	5.5	380	2850	80	79×28×34
WQ70-12-5.5SQG	70	12	5.5	380	2850	100	79×28×34
WQ20-40-7.5SQG	20	40	7.5	380	2850	50	79×28×34
WQ30-32-7.5SQG	30	32	7.5	380	2850	65	79×28×34
WQ45-22-7.5SQG	45	22	7.5	380	2850	80	79×28×34
WQ70-17-7.5SQG	70	17	7.5	380	2850	100	79×28×34
WQ140-10-7.5SQG	140	10	7.5	380	2850	150	79×28×34

## WQ(D)-S

Stainless steel precision casting  
submersible sewage pump B section

### 不锈钢精密铸造

污水污物潜水电泵B款

#### 产品概述/Product Description

- 1.WQ(D)-S不锈钢精密铸造污水污物潜水电泵采用不锈钢精密铸造泵壳,无缝管电机外壳具有耐腐蚀,环保型,扬程高,流量大等特点。
- 2.油室采用氟橡胶双面机械密封,外室采用单面氟橡胶机械油封结构,有效地减少因骨架油封与轴之间摩擦而造成的密封进水问题。
- 3.电机采用高温线, F级绝缘, 热保护装置, 有效地延长泵的使用寿命。
- 4.根据客户的要求, 可带搅匀装置, 该装置随电机轴旋转产生极强的搅拌力, 将污水池内的沉积物拌成悬浮物后排出。也可带切割装置, 能将污水中的长纤维, 塑料, 纸袋, 稻草等杂物碎片后排出。

1. WQ(D)-S stainless steel precision casting sewage sewage submersible pump adopts stainless steel precision casting pump casing, seamless tube motor casing has the characteristics of corrosion resistance, environmental protection, high lift and large flow.
2. Oil chamber adopts fluorine rubber-double face seal and out chamber flow fluorine rubber-single face seal, which is effectively to avoid the water seepage.
3. Motor adopts high temperature winding with F class insulation, equiped seepage with thermal protection device, making the long service life longer.
4. According to the customer's request, it can be equipped with a stirring device. The device generates a strong stirring force with the rotation of the motor shaft, and the sediment in the sewage pool is mixed into a suspended matter and discharged. It can also be equipped with a cutting device to discharge long debris, plastic, paper bags, straw and other debris in the sewage.

#### 应用范围/Application Range

适用于建筑楼宇、医院、住宅小区、市政工程、道路交通及施工、工厂排污、养殖、药业、饮料、海水盐池、一般腐蚀性介质中含有的固体颗粒、长纤维废水、污水。

Applicable to building buildings, hospitals, residential quarters, municipal engineering, road traffic and construction, factory sewage, aquaculture, pharmaceuticals, beverages, seawater brine, solid particles contained in general corrosive media, long fiber wastewater and sewage.

#### 使用条件/Conditions Of Use

1. 以叶轮中心为准, 潜入水下深度不得超过5m;
2. 输送介质温度不高于60°C;
3. 输送介质的PH值304(4-10),316(4-13);
4. 输送介质的运动黏度为 $7 \times 10^{-7} \sim 23 \times 10^{-6} \text{m}^2/\text{s}$

产品材料耐腐蚀性能详情请参考P39-40

1. According to the center of the impeller, the max immersion depth is 5m
2. Max temperature of the conveying is 60°C
3. The PH value of convey temperature is 304(4-10),316(4-13)
4. Kinematic viscosity of transport medium is  $7 \times 10^{-7} \sim 23 \times 10^{-6} \text{m}^2/\text{s}$

Please refer to P39-40 for details of corrosion resistance of product materials.

#### 型号说明/Model Description

WQ 10 - 10 - 0.75 S

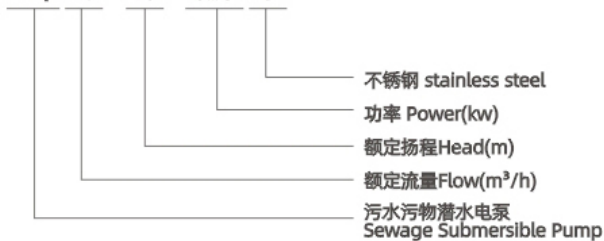

#### 技术参数/Technical Parameters

产品型号 Model	额定流量 Flow (m <sup>3</sup> /h)	额定扬程 Lift (m)	功率 Rate power (kw)	电压 Rated voltage (V)	口径 callber (mm)	转速 Rotating speed (r/min)
WQD10-10-0.75S	10	10	0.75	220	50	2850
WQD7-15-1.1S	7	15	1.1	220	50	2850
WQ10-10-0.75S	10	10	0.75	380	50	2850
WQ7-15-1.1S	7	15	1.1	380	50	2850
WQD15-15-1.5S	15	15	1.5	220	50	2850
WQ15-15-1.5S	15	15	1.5	380	50	2850
WQ15-20-2.2S	15	20	2.2	380	50	2850
WQ25-15-2.2S	25	15	2.2	380	65	2850
WQ40-9-2.2S	40	9	2.2	380	80	2850
WQ15-25-3S	15	30	3	380	50	2850
WQ25-20-3S	25	20	3	380	65	2850
WQ40-15-3S	40	15	3	380	80	2850
WQ15-32-4S	15	32	4	380	50	2850
WQ25-25-4S	25	25	4	380	65	2850
WQ40-18-4S	40	18	4	380	80	2850
WQ50-15-4S	50	15	4	380	100	2850
WQ15-40-5.5S	15	40	5.5	380	50	2850
WQ30-25-5.5S	30	25	5.5	380	65	2850
WQ50-18-5.5S	50	18	5.5	380	80	2850
WQ70-15-5.5S	70	15	5.5	380	100	2850
WQ100-8-5.5S	100	8	5.5	380	150	2850
WQ20-40-7.5S	20	40	7.5	380	50	2850
WQ30-32-7.5S	30	32	7.5	380	65	2850
WQ45-22-7.5S	45	22	7.5	380	80	2850
WQ80-20-7.5S	80	20	7.5	380	100	2850
WQ100-15-7.5S	100	15	7.5	380	150	2850

**WQ(D)-S**  
Stainless steel precision casting  
submersibles ewage pump(Wire Effluent)

**不锈钢精密铸造**  
污水污物潜水电泵(丝口出水)

**产品概述/Product Description**

- 1.WQ(D)-S不锈钢精密铸造小型潜水电泵采用不锈钢精密铸造外壳,耐腐蚀,环保型,外观美观,体积小,经久耐用。
- 2.采用氟橡胶双端面机封,氟橡胶径向O型圈密封,有效对环境恶劣的液体进行密封保护作用。
- 3.电机采用F级绝缘,装有热保护装置,大大延长了泵的使用寿命。

**应用范围/Application Fange**

适用于工矿企业,食品行业,海水养殖,景观工程,深井提水,农用灌溉等一般腐蚀性介质。

产品材料耐腐蚀性能详情请参考P39-40  
Please refer to P39-40 for details of corrosion resistance of product materials.

**型号说明/Model Description**

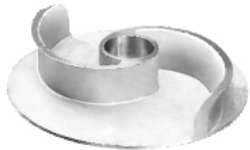
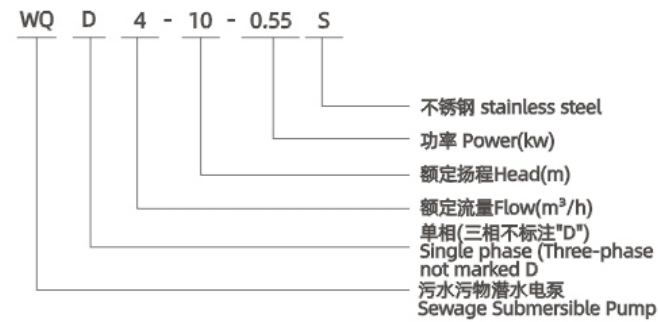

**性能曲线/Performance Curve**

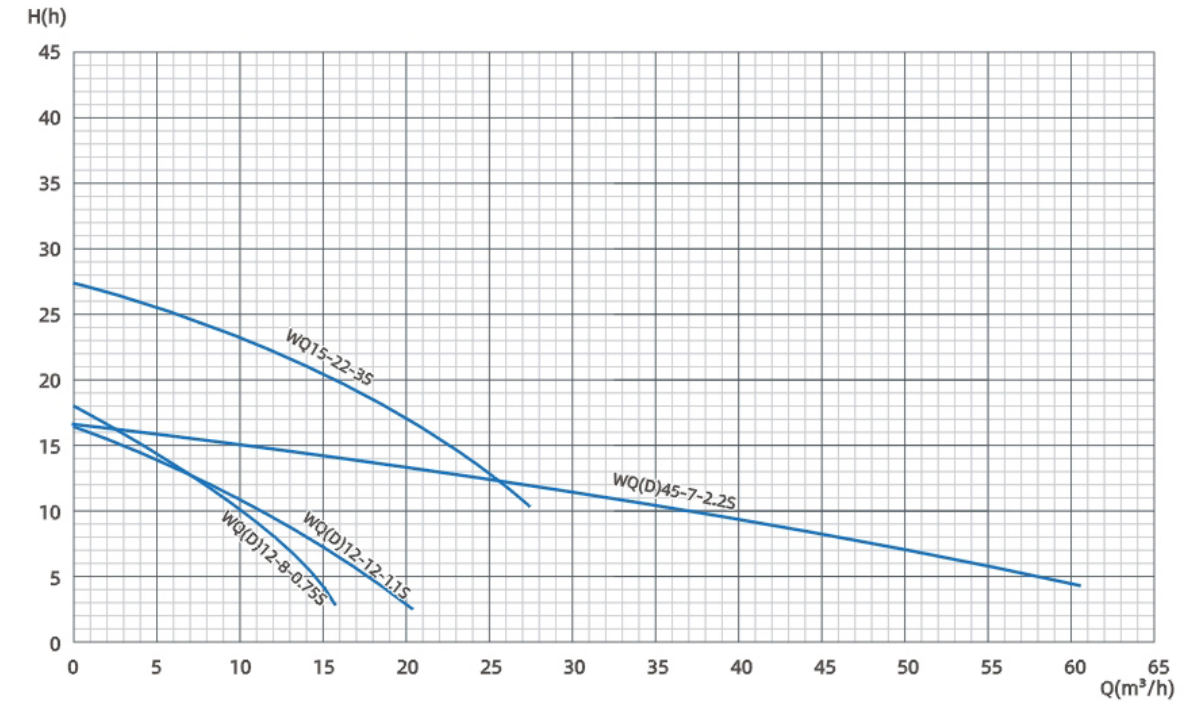

**技术参数/Technical Parameters**

产品型号 Model	额定流量 Flow (m <sup>3</sup> /h)	额定扬程 Lift (m)	功率 Rate power (kw)	电压 Rated voltage (V)	口径 caliber (mm)	包装尺寸 长×宽×高 Package dimensions Length × width × height (cm)
WQ(D)3-7-0.25S	3	7	0.25	220/380	25	43×19×24
WQ(D)3-9-0.37S	3	9	0.37	220/380	25	43×19×24
WQ(D)5-7-0.37S	5	7	0.37	220/380	32	43×19×24
WQ(D)7-5-0.37S	7	5	0.37	220/380	40	43×19×24
WQ(D)4-10-0.55S	4	10	0.55	220/380	32	43×19×24
WQ(D)7-7-0.55S	7	7	0.55	220/380	40	47×17×22
WQ(D)5-15-0.75S	5	15	0.75	220/380	32	47×17×22
WQ(D)10-9-0.75S	10	9	0.75	220/380	40	47×17×22
WQ(D)12-8-0.75S	12	8	0.75	220/380	50	43×19×24
WQ(D)15-6-0.75S	15	6	0.75	220/380	65	43×19×24
WQ(D)8-15-1.1S	8	15	1.1	220/380	40	43×19×24
WQ(D)12-12-1.1S	12	12	1.1	220/380	50	43×19×24
WQ(D)20-6-1.1S	20	6	1.1	220/380	65	47×17×22
WQ(D)6-18-1.5S	6	18	1.5	220/380	40	47×17×22
WQ(D)15-12-1.5S	15	12	1.5	220/380	50	47×17×22
WQ(D)25-7-1.5S	25	7	1.5	220/380	65	54×22×25
WQ(D)9-22-2.2S	9	22	2.2	220/380	50	54×22×25
WQ(D)25-12-2.2S	25	12	2.2	220/380	65	54×22×25
WQ(D)45-7-2.2S	45	7	2.2	380	80	58×22×26
WQ15-22-3S	15	22	3	380	50	58×22×26
WQ25-15-3S	25	15	3	380	65	58×22×26
WQ50-10-3S	50	10	3	380	80	58×22×26



**WQ(D)X-S**  
Stainless steel precision casting  
High-lift sewage pump (Wire Effluent)

**不锈钢精密铸造**  
高扬程污水泵(丝口出水)

**产品概述/Product Description**

- 1.WQ(D)X-S系列不锈钢高扬程污水泵采用不锈钢精密铸造外壳,具有耐腐蚀性,环保型,扬程高,流量大等特点。
- 2.采用氟橡胶双端面机封,氟橡胶径向O型圈密封,有效对环境恶劣的液体进行密封保护作用
- 3.电机采用高温线, F级绝缘, 热保护装置, 有效地延长泵的使用寿命
- 4.该泵特点扬程高、适用工矿、建筑、海水养殖。

1. WQ(D)X- S series stainless steel high head sewage pump is made of stainless steel precision casting shell, which has the characteristics of corrosion resistance, environmental protection, head distance and large flow.
2. It adopts fluoro rubber double-face machine seal and fluoro rubber radial ring seal to effectively seal and protect the environment from harsh liquids.
3. The motor adopts high temperature line, F grade insulation and thermal protection device to effectively extend the service life of the pump.
4. The pump features in high head, which is suitable for mining, construction and marine aquaculture.

**应用范围/Application Range**

适用于建筑楼宇、医院、住宅小区、市政工程、道路交通及施工、工厂排污、养殖、药业、饮料、海水盐业、一般腐蚀性介质中含有的较小的固体颗粒、废水、污水。

Applicable to building buildings, hospitals, residential quarters, municipal engineering, road traffic and construction, factory sewage, aquaculture, pharmaceuticals, beverages, seawater brine, small solid particles, wastewater, sewage in general corrosive media.

**使用条件/Conditions Of Use**

1. 以叶轮中心为准, 潜入水下深度不得超过5m;
2. 输送介质温度不高于60°C;
3. 输送介质的PH值304(4-10), 316(4-13);
4. 输送介质的运动黏度为 $7 \times 10^{-7} \sim 23 \times 10^{-6} \text{m}^2/\text{s}$

产品材料耐腐蚀性能详情请参考P39-40

1. According to the center of the impeller, the max immersion depth is 5m
2. Max temperature of the conveying is 60°C
3. The PH value of convey temperature is 304(4-10), 316(4-13)
4. Kinematic viscosity of transport medium is  $7 \times 10^{-7} \sim 23 \times 10^{-6} \text{m}^2/\text{s}$

Please refer to P39-40 for details of corrosion resistance of product materials.

**型号说明/Model Description**

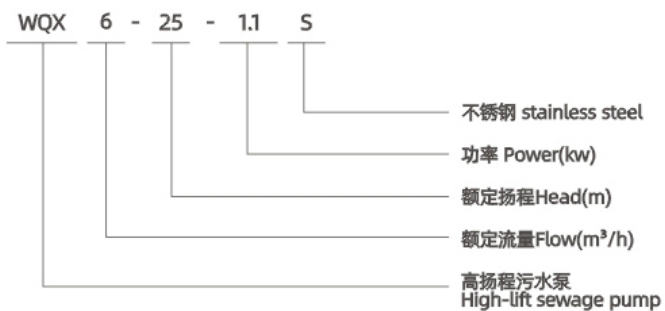

**性能曲线/Performance Curve**

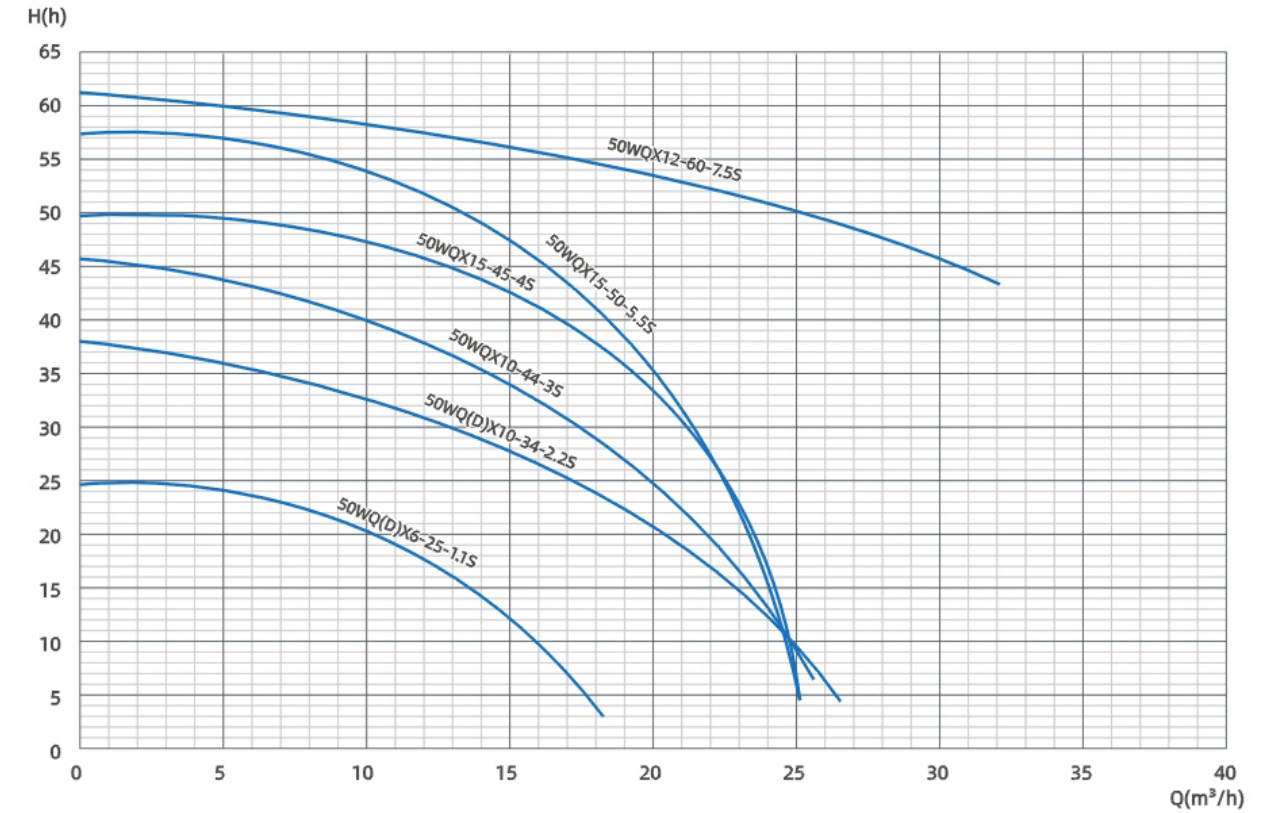

**技术参数/Technical Parameters**

产品型号 Model	额定流量 Flow (m³/h)	额定扬程 Lift (m)	功率 Rate power (kw)	电压 Rated voltage (V)	口径 caliber (mm)	包装尺寸 长×宽×高 Package dimensions Length × width × height (cm)
WQ(D)X6-25-1.1S	6	25	1.1	220/380	50	54×22×25
WQ(D)X10-34-2.2S	10	34	2.2	220/380	50	58×22×26
WQX10-44-3S	10	44	3	380	50	72×28×33
WQX15-45-4S	15	45	4	380	50	72×28×33
WQX15-50-5.5S	15	50	5.5	380	50	86×35×40
WQX12-60-7.5S	12	60	7.5	380	50	86×35×40

## Q(D)X-S

Stainless steel precision casting

Small submersible electric pump (Wire Effluent)

不锈钢精密铸造

小型潜水电泵(丝口出水)

### 产品概述/Product Description

1. Q(D)X-S 不锈钢精密铸造小型潜水电泵采用不锈钢精密铸造外壳，耐腐蚀，环保型，外型美观，体积小，经久耐用。
  2. 采用氟橡胶双端面机封，氟橡胶径向O型圈密封，有效对环境恶劣的液体进行密封保护作用。
  3. 电机采用F级绝缘，装有热保护装置，大大延长了泵的使用寿命。
1. Q(D)X-S stainless steel precision casting small submersible pump adopts stainless steel precision casting shell, corrosion-resistant, environment-friendly, beautiful appearance, small size and durable.
  2. It adopts fluoro rubber double-face machine seal and fluoro rubber radial ring seal to effectively seal and protect the environment from harsh liquids.
  3. The motor adopts Class F insulation and is equipped with thermal protection device, which greatly prolongs the service life of the pump.

### 应用范围/Application Range

适用于工矿企业，食品行业，海水养殖，景观工程，深井提水，农用灌溉等一般腐蚀性介质。  
Applicable to industrial and mining enterprises, food industry, marine aquaculture, landscape engineering, deep well water extraction, agricultural irrigation and other general corrosive media.

产品材料耐腐蚀性能详情请参考P39-40  
Please refer to P39-40 for details of corrosion resistance of product materials.

### 型号说明/Model Description

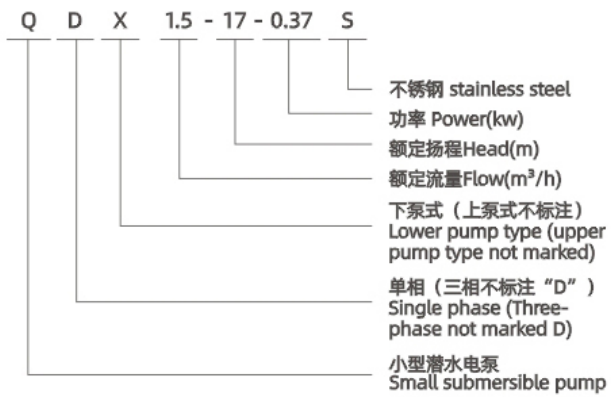

### 性能曲线/Performance Curve

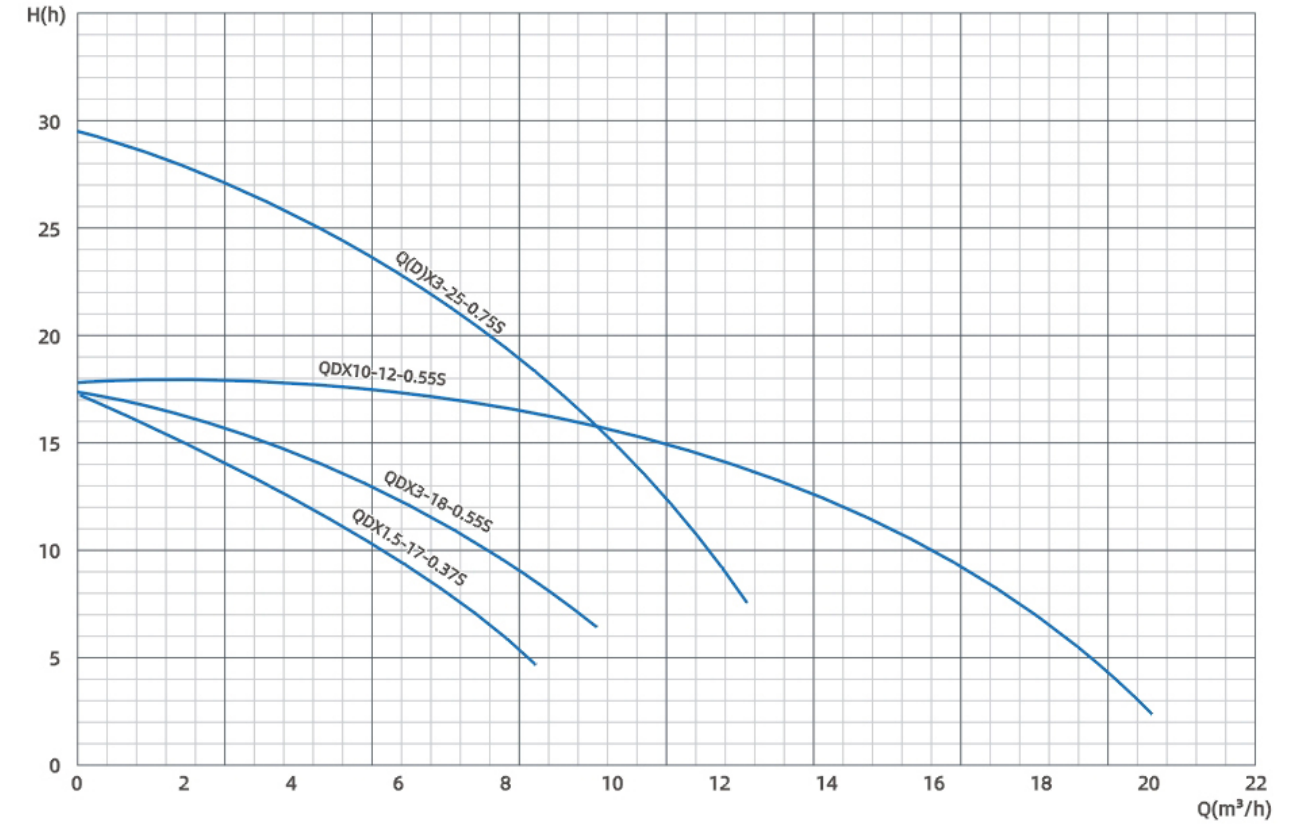

### 技术参数/Technical Parameters

产品型号 Model	额定流量 Flow (m <sup>3</sup> /h)	额定扬程 Lift (m)	功率 Rate power (kw)	电压 Rated voltage (V)	口径 caliber (mm)	包装尺寸 长×宽×高 Package dimensions Length × width × height (cm)
QDX1.5-17-0.37S	1.5	17	0.37	220	25	35×15×19
QDX3-18-0.55S	3	18	0.55	220	25	43×19×24
QDX10-12-0.55S	10	12	0.55	220	50	43×19×24
Q(D)X3-25-0.75S	3	25	0.75	220/380	25	43×19×24
Q(D)X6-18-0.75S	6	18	0.75	220/380	40	43×19×24
Q(D)X10-16-0.75S	10	16	0.75	220/380	50	43×19×24
Q(D)X3-30-1.1S	3	30	1.1	220/380	25	43×19×24
Q(D)X6-20-1.1S	6	20	1.1	220/380	40	43×19×24
Q(D)X10-18-1.1S	10	18	1.1	220/380	50	43×19×24

**WQ/Q(D)X-S**  
**Stainless steel small submersible/**  
**sewage electric pump (stamping parts)**  
**不锈钢小型潜水/污水电泵(冲压件)**

**产品概述/Product Description**

- 1.WQ/Q(D)X-S不锈钢小型潜水/污水电泵采用不锈钢冲压外壳,耐腐蚀,环保型,外型美观,体积小,经久耐用。
  - 2.采用氟橡胶双端面机封,氟橡胶径向O型圈密封,有效对环境恶劣的液体进行密封保护作用。
  - 3.电机采用F级绝缘,装有热保护装置,大大延长了泵的使用寿命。
1. WQ/Q(D)X-S stainless steel small submersible/sewage electric pump adopts stainless steel stamping shell, corrosion-resistant, environment -friendly, beautiful appearance, small size and durable.
  2. It adopts fluoro rubber double-face machine seal and fluoro rubber radial seal to effectively seal and protect the environment from harsh liquids.
  3. The motor adopts Class F insulation and is equipped with thermal protection device, which greatly prolongs the service life of the pump.

**应用范围/Application Range**

适用于工矿企业, 食品行业, 海水养殖, 景观工程, 深井提水, 农用灌溉等一般腐蚀性介质。  
Applicable to industrial and mining enterprises, food industry, marine aquaculture, landscape engineering, deep well water extraction, agricultural irrigation and other general corrosive media.

产品材料耐腐蚀性能详情请参考P39-40  
Please refer to P39-40 for details of corrosion resistance of product materials.

**型号说明/Model Description**

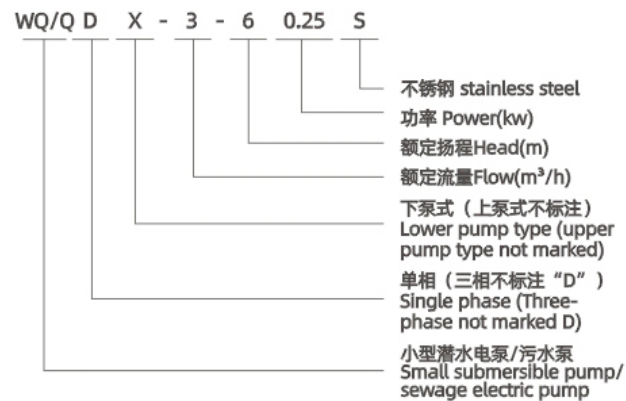

**技术参数/Technical Parameters**

产品型号 Model	额定流量 Flow (m <sup>3</sup> /h)	额定扬程 Lift (m)	功率 Rate power (kw)	电压 Rated voltage (V)	口径 caliber (mm)	包装尺寸 长×宽×高 Package dimensions Length × width × height (cm)
WQ(D)7-15-0.75S	7	15	0.75	220/380	40	45×26×20
WQ(D)10-12-0.75S	10	12	0.75	220/380	50	45×26×20
WQ(D)8-16-1.1S	8	16	1.1	220/380	40	45×26×20
WQ(D)12-13-1.1S	12	13	1.1	220/380	50	45×26×20
WQ(D)8-18-1.5S	8	18	1.5	220/380	40	45×26×20
WQ(D)8-18-1.5S	8	18	1.5	220/380	50	45×26×20

**技术参数/Technical Parameters**

产品型号 Model	额定流量 Flow (m <sup>3</sup> /h)	额定扬程 Lift (m)	功率 Rate power (kw)	电压 Rated voltage (V)	口径 caliber (mm)	包装尺寸 长×宽×高 Package dimensions Length × width × height (cm)
Q(D)X3-6-0.25S	3	6	0.25	220	25	38×22×19
Q(D)X1.5-17-0.37S	1.5	17	0.37	220	25	38×22×19
Q(D)X3-18-0.55S	3	18	0.55	220	25	45×26×20
Q(D)X10-12-0.55S	10	12	0.55	220	50	45×26×20
Q(D)X3-22-0.75S	3	22	0.75	220/380	25	45×26×20
Q(D)X7-18-0.75S	7	18	0.75	220/380	40	45×26×20
Q(D)X10-16-0.75S	10	16	0.75	220/380	50	45×26×20
Q(D)X3-26-1.1S	3	26	1.1	220/380	25	45×26×20
Q(D)X7-20-1.1S	7	20	1.1	220/380	40	45×26×20
Q(D)X10-18-1.1S	10	18	1.1	220/380	50	45×26×20
Q(D)X3-30-1.5S	3	30	1.5	220/380	25	45×26×20
Q(D)X7-22-1.5S	7	22	1.5	220/380	40	45×26×20
Q(D)X10-20-1.5S	10	20	1.5	220/380	50	45×26×20

**QY-S**  
Stainless steel precision casting  
Oil-filled submersible pump

**不锈钢精密铸造**  
油浸式潜水电泵

**产品概述/Product Description**

QY-S系列充油式潜水电泵(以下简称电泵)由水泵、密封和电动机三部分组成,水泵位于电泵上部,为离心式或轴流结构。电动机位于电泵下部,为充油式三相异步电动机。水泵与电动机之间采用双端机械密封,各固定止口密封处采用“O”形耐油橡胶做静密封。

QY-S series oil-filled submersible pump (hereinafter referred to as electric pump) consists of three parts: water pump, seal and electric motor. The pump is located in the upper part of the electric pump. It is a centrifugal or axial flow structure. The motor is located at the lower part of the electric pump and is oil-filled. Three-phase asynchronous motor. A double-end mechanical seal is used between the water pump and the motor, and the fixed seals are made of "oil-resistant rubber" for static sealing.

**应用范围/Application Range**

该系列电泵由于流量及扬程的适用范围极广,是广大农村、工矿企业广泛适用的电力排灌设备,适用于煤矿排水、农业排灌、园林排灌、井下提水、水塔送水、城建用水、海水养殖等给排水。

This series of electric pumps is widely used in rural and industrial and mining enterprises. Due to its wide range of flow and head, it is suitable for coal mine drainage, agricultural irrigation and drainage, garden drainage, underground water pumping, water tower water supply. Water supply and drainage for urban construction water, marine aquaculture, etc.

**使用条件/Conditions Of Use**

1. 以叶轮中心为准,潜入水下深度不得超过5m;
2. 输送介质温度不高于60°C;
3. 输送介质的PH值304(4-10),316(4-13);
4. 输送介质的运动粘度为 $7 \times 10^{-7} \sim 23 \times 10^{-6} \text{m}^2/\text{s}$

产品材料耐腐蚀性能详情请参考P39-40

1. According to the center of the impeller, the max immersion depth is 5m
2. Max temperature of the conveying is 60°C
3. The PH value of convey temperature is 304(4-10),316(4-13)
4. Kinematic viscosity of transport medium is  $7 \times 10^{-7} \sim 23 \times 10^{-6} \text{m}^2/\text{s}$

Please refer to P39-40 for details of corrosion resistance of product materials.

**型号说明/Model Description**

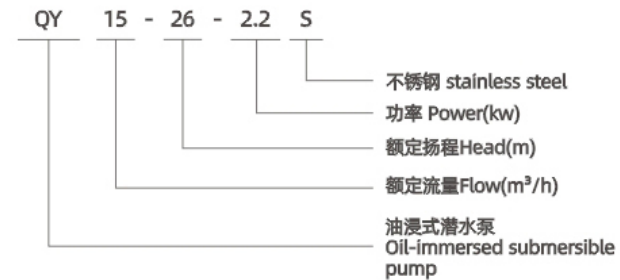

**技术参数/Technical Parameters**

产品型号 Model	额定流量 Flow (m <sup>3</sup> /h)	额定扬程 Lift (m)	功率 Rate power (kw)	电压 Rated voltage (V)	口径 caliber (mm)	水泵高度 Pump height (mm)	最大外径 Maximum outer diameter (mm)	中心距 Center distance (mm)	孔数 Number of holes
QY15-26-2.2S	15	26	2.2	380	50	555	255	99	4
QY25-17-2.2S	25	17	2.2	380	65	545	245	99	4
QY40-12-2.2S	40	12	2.2	380	80	600	250	105	4
QY65-7-2.2S	65	7	2.2	380	100	572	225	160	6
QY100-4.5-2.2S	100	4.5	2.2	380	150	595	225	160	6
QY15-36-3S	15	36	3	380	50	590	280	99	4
QY25-26-3S	25	26	3	380	65	580	255	99	4
QY40-16-3S	40	16	3	380	80	625	250	105	4
QY65-10-3S	65	10	3	380	100	597	225	160	6
QY100-6-3S	100	6	3	380	150	620	225	160	6
QY40-21-4S	40	21	4	380	80	635	275	105	4
QY65-14-4S	65	14	4	380	100	645	260	160	6
QY100-9-4S	100	9	4	380	150	720	250	190	6
QY160-5.5-4	160	5.5	4	380	200	730	250	190	6
QY25-40-5.5S	25	40	5.5	380	65	690	320	99	4
QY40-28-5.5S	40	28	5.5	380	80	700	310	105	4
QY65-18-5.5S	65	18	5.5	380	100	715	310	160	6
QY100-12-5.5S	100	12	5.5	380	150	755	290	190	6
QY160-8-5.5S	160	8	5.5	380	200	755	290	190	6
QY40-38-7.5S	40	38	7.5	380	80	700	320	105	4
QY65-25-7.5S	65	25	7.5	380	100	715	310	160	6
QY200-8-7.5S	200	8	7.5	380	150/200	810	290	190	6



不锈钢泵常见机械密封、密封材料的耐腐蚀性参考表  
Stainless Steel Pump Common Mechanical Seal, Sealing Material Corrosion Resistance Reference Table

序号 NO.	介质名称 medium	丁腈胶 Nitrile rubber	氯丁胶 neoprene	氟橡胶 Fluorine rubber	聚四氟乙烯 polytetrafluoroethylene
1	发烟硝酸 Fuming Nitric Acid	X	X	B	A
2	浓硝酸 Concentrated nitric acid	X	X	B	A
3	浓硫酸 Concentrated sulfuric acid	X	X	A	A
4	浓盐酸 Concentrated hydrochloric acid	X	B	B	A
5	浓磷酸 Concentrated phosphoric acid	X	B	B	A
6	浓醋酸 Concentrated acetic acid	X	X	X	A
7	浓苛性钠 Concentrated sodium	A	A	B	A
8	无水氨 Anhydrous ammonia	B	B	B	A
9	稀硝酸 Dilute nitric acid	X	X	A	A
10	稀硫酸 Dilute sulfuric acid	B	B	B	A
11	稀盐酸 Dilute hydrochloric acid	X	A	B	A
12	稀醋酸 Dilute acetic acid	X	X	B	A
13	稀苛性钠 Dilute sodium	A	A	B	A
14	氨水 ammonia	B	B	X	A
15	苯 benzene	X	X	A	A
16	汽油 gasoline	A	A	A	A
17	石油 oil	B	B	A	A
18	四氯化碳 Carbon tetrachloride	A	X	A	A
19	二硫化碳 Carbon disulfide	A	X	-	A
20	乙醇 Ethanol	A	A	A	A
21	丙醇 Propyl alcohol	X	B	X	A
22	甲酚 Cresol	X	B	B	A
23	乙醛 Acetaldehyde	B	X	-	A
24	乙苯 Ethylbenzene	X	X	-	A
25	丙烯腈 Acrylonitrile	X	B	X	A
26	丁二烯 Butadiene	B	-	-	A
27	苯乙烯 Styrene	X	X	-	A
28	醋酸乙酯 Ethyl acetate	X	X	X	A
29	醚 (常温) / Ether (normal temperature)	X	X	X	A

耦合安装尺寸/Coupling installation size

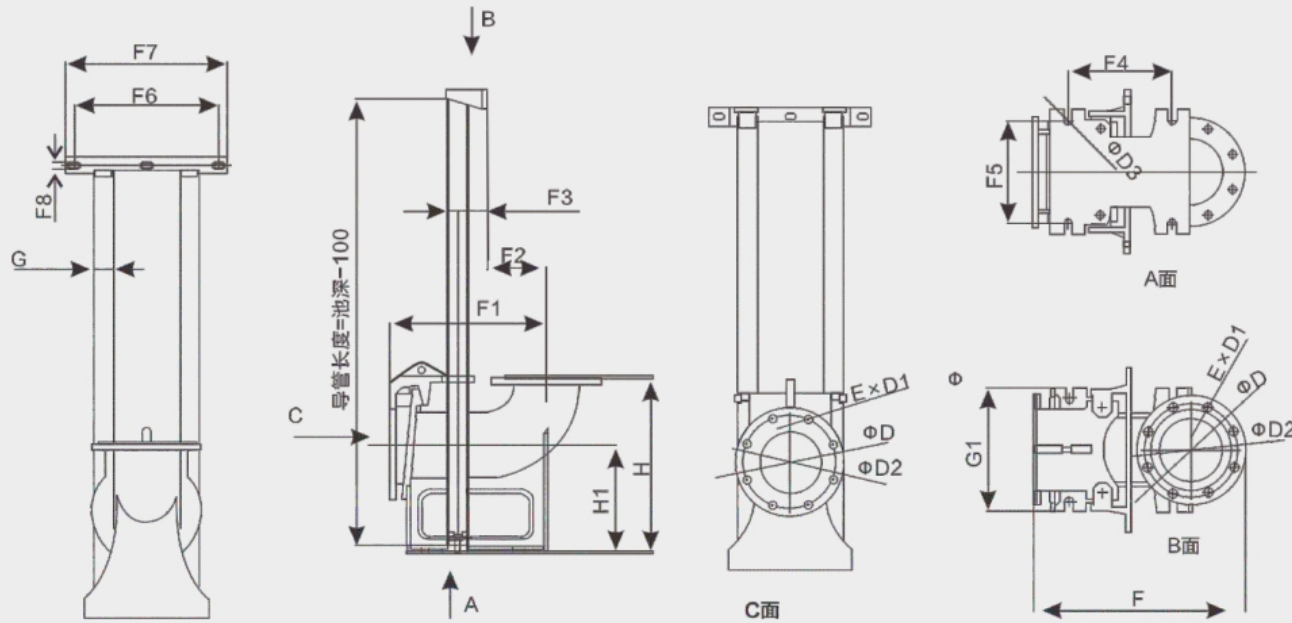

耦合安装尺寸/Coupling installation size

产品型号 Model	D	D1	D2	D3	E	F	F1	F2	F3	F4	F5	F6	F7	F8	G	G1	H	H1
DN50	110	14	50	16	4	265	195	58	62	115	113	215	255	12	1寸	130	215	133
DN65	130	14	65	16	4	295	215	55	65	132	135	215	255	12	1寸	160	246	150
DN80	150	18	80	16	4	340	245	65	75	160	160	266	315	12	1.5寸	185	280	170
DN100	170	18	100	20	4	370	268	80	90	192	160	305	355	14	1.5寸	206	330	195
DN150	225	18	150	20	8	515	385	147	70	252	252	350	395	14	1.5寸	310	425	260
DN200	280	18	200	20	8	560	400	200	80	320	285	300	400	16	2寸	360	520	315

注1: "A" 代表满足, "B" 代表适用, "x" 不适用

注2: 本表仅作参考, 不得作为产品选型依据和标准, 选型前请咨询相关行业专家, 否则因此造成损失, 我司概不负责。

Note 1: "A" means yes, "B" means suitable, and "X" means no

Note 2: This table is for reference only, and cannot be used as the basis and standard of product selection. Consult relevant experts before type selection, and we will not be responsible for any loss caused by this

不锈钢材料耐腐蚀性参考表  
Stainless steel material corrosion resistance reference table

序号 NO.	介质名称 medium	使用条件 Conditions of Use	304	316	316L
1	盐酸	<1%, 20°C以下	x	x	B
2	硫酸	5%~20%, 40°C以下	x	B	A
3		>20%~50%, 40°C以下	x	x	x
4		浓, 20°C以下	B	A	A
5		浓, 20°C以上	x	x	x
6	硝酸	≤65%, 20°C以下	A	A	A
7		浓, 20°C以下	A	A	A
8		≤65%, 20°C以上	B	B	B
9		浓, 20°C以上	A	A	A
10	磷酸	浓发烟, 43°C以下	A	A	A
11		浓发烟, 43°C以上	A	A	A
12		1%~4%, 20°C~沸腾	A	A	A
13		5%~9%, 静止或搅拌或充气	A	A	A
14	磷酸	10%~79%, 静止	A	A	A
15		10%~79%, 搅拌或充气	A	B	B
16		10%~79%, 50°C~沸腾	B	A	A
17		≥80%, 20°C~沸腾	x	B	A
18	醋酸	5~49%, 搅拌或充气	A	A	A
19		50~100%, 20°C以下	A	A	A
20		50~100%, 20°C以上	x	x	B
21		碳酸	饱和以下	A	A
22	草酸	10~50%, 20°C以下	A	A	A
23		10~50%, 20°C以上	x	x	x
24	乳酸	<5%, 20°C以下	A	A	A
25		5%~10%, 20°C以下	B	A	A
26		<5%, 20°C以上	A	A	A
27		5%~10%, 20°C以上	B	A	A
28	硫酸钙	>10%, 20°C以上	x	B	B
29		饱和以下	A	A	A
30		≤5%, 搅拌或充气	A	A	A
31		5%~饱和	A	A	A
32	硫酸钡	饱和以下	B	A	A
33	硫酸镁		A	A	A
34	硫酸镍		A	A	A
35	硫酸钾		A	A	A
36	硫酸钠		A	A	A
37	硫酸铝	5%~饱和, 20°C以下	A	A	A
38		10%~饱和, 沸腾	A	A	A
39	硫酸铜(II)	≤5%, 静止或搅拌或充气	A	A	A
40		饱和	A	A	A
41	硫酸铁	稀释液	A	A	A
42	酸铁(III)	≤5%, 搅拌或充气	A	A	A
43	硫酸铝钾	≤10%	A	A	A
44		≤10%, 20°C以下	A	A	A
45		>10%, 20°C以上	B	A	A
46		饱和	x	B	A
47	硫酸氢钠	非饱和	A	A	A
48		饱和	x	x	x
49	亚硫酸钠	<10%	A	A	A
50	亚硫酸钾		A	A	A
51	草酸铵	<5%	A	A	A
52	碳酸铵	<5%	A	A	A
53	碳酸钡		A	A	A
54	碳酸钾	≤1%, 20°C以下	A	A	A
55		≤1%, 20°C以上	A	A	A
56	硫化氢	干	A	A	A
57		湿	B	A	A
58	硫化钠	饱和	B	A	A
59	硫化钡	饱和和液苯(粗苯)	A	A	A
60	氯化铝		A	A	A
61	氯化硫	干	x	x	x
62	氯化钡		A	A	A
63	氯化镁	≤5%静止, 20°C以下	A	A	A
64		≤5%静止, 20°C以上	x	x	B
65	氯化钙	稀释或浓缩	B	A	A
66	氯化镍		A	A	A
67	氯化锌	50%以下, 静止	x	B	B
68		20°C以上	x	B	B
69	氯化铵	≤10%	A	A	A
70		大于10%	B	B	A
71	氯化钾		A	A	A
72			A	A	A
73	氯化镉IV		x	x	x
74	氯化镉II	<5%静止或搅拌或充气	x	A	A
75	氯化铁II	<5%, 沸腾	x	A	A
76	氯化铁(III)	1.5g/L溶液	B	B	A
77		饱和	x	x	x
78		饱和	x	x	x
79	氯化钠	≤1%, 20°C以下	A	A	A
80		≤1%, 20°C以上	B	A	A
81		>1%	B	B	A
82	饮用水	≤5%, 沸腾以下, 充气	A	A	A
83	海水	5~20%, 20°C以下, 充气	x	B	A
84	麦芽汁	饱和, 静止, 20°C以下	A	A	A

注1: "A" 代表满足, "B" 代表适用, "x" 不适用  
注2: 本表仅作参考, 不得作为产品选型依据和标准, 选型前请咨询相关行业专家, 否则因此造成损失, 我司概不负责。

Note 1: "A" means yes, "B" means suitable, and "X" means no  
Note 2: This table is for reference only, and cannot be used as the basis and standard of product selection. Consult relevant experts before type selection, and we will not be responsible for any loss caused by this

不锈钢材料耐腐蚀性参考表  
Stainless steel material corrosion resistance reference table

序号 NO.	介质名称 medium	使用条件 Conditions of Use	304	316	316L
85	麦芽浆		A	A	A
86	柠檬酸	≤15%, 静止, 20°C以下	A	A	A
87		>15%, 20°C以上	B	A	A
88	苦味酸		A	A	A
89	硬脂酸		A	A	A
90	酒石酸	≤10%, 20°C以下	A	A	A
91		10~50%, 20°C以上	B	A	A
92	单宁酸	20~66°C	A	A	A
93	硼酸		A	A	A
94	硅酸 (氢氟硅酸)		X	X	X
95	甲酸	<5%, 静止, 20~66°C	B	A	A
96	丁酸	≤5%	A	A	A
97		0.964g/L水溶液	A	A	A
98	苯甲酸		A	A	A
99	氟乙酸	任何浓度	X	X	X
100	碳酸碱	≤5%	A	A	A
101	亚硫酸	饱和, 4~8巴	A	A	A
102		10巴	B	A	A
103	氢氟酸		X	X	X
104	氢氟酸		X	X	X
105	苹果酸		A	A	A
106	碳酸钠	<50%, 66°C以下	A	A	A
107		<50%, 沸腾	B	A	A
108		<50%熔态	X	X	X
109	碳酸钙	饱和	A	A	A
110	碳酸碱	饱和	A	A	A
111	碳酸氢钠	各种浓度, 20°C以下	A	A	A
112		<50%, 66°C, 静止	A	A	A
113	碳酸氢铵		A	A	A
114		1~5%静止或搅拌或充气	A	A	A
115	硝酸铜(II)	5~50%, 水溶液	A	A	A
116		热水溶液	A	A	A
117	硝酸钾	各种浓度或熔态	A	A	A
118	硝酸钠		A	A	A
119	硝酸银		A	A	A
120	硝酸铋		A	A	A
121	硝酸镁(III)	≤5%, 静止或搅拌或充气	A	A	A
122	硝酸铵	沸腾	A	A	A
123	氟酸钾	饱和, 100°C	A	A	A
124	高锰酸钾	≤5%	A	A	A
125	氟酸钙	稀释溶液	A	A	A
126	次氯酸钠	≤5%, 静止	B	A	A
127	高氯酸钠	≤10%, 沸腾	A	A	A
128	高氯酸铵		A	A	A
129	次氯酸钾		B	B	B
130	草酸氢钾	≤25%	A	A	A
131	重铬酸钾	≤5%	A	A	A
132	氟化钠		B	A	A
133	溴化钾		B	A	A
134			B	A	A
135	溴化铵		A	A	A
136	氟化钾		A	A	A
137	氟化钠		A	A	A
138	氟化铋	湿	A	A	A
139	氟氧化铜II	饱和	A	A	A
140	氟氧化钙	≤20%	A	A	A
141	氢氧化钡	热水溶液	A	A	A
142	氢氧化铋III		A	A	A
143		≤27%	B	B	B
144	氢氧化镁	28~50%, 20°C以上	B	A	A
145	氢氧化铵		A	A	A
146	氢氧化铝	≤5%	A	A	A
147	氢氧化铟	饱和	A	A	A
148	三硫化硫		A	A	A
149		干	A	A	A
150	二硫化硫	湿	A	A	A
151	二硫化碳		B	B	B
152	过氧化氢		A	A	A
153	无水氨		B	B	B
154	热水体	各种浓度	A	A	A
155	粗氨水		X	X	X
156	清漆		A	A	A
157	树脂		A	A	A
158	甲醇		A	A	A
159	乙醇	沸腾以下	X	B	B
160	丁烷	50°C~20°C	A	A	A
161	丙烷	50°C~20°C	A	A	A
162	甲醛	≤40%, 溶液	A	A	A
163	苯胺	≤3%	A	A	A
164	浓缩粗苯胺		A	A	A
165	丙酮	沸腾以下	A	A	A
166	苯酚		A	A	A
167	墨水		B	B	B
168	甲影液		A	A	A
169	碘仿		A	A	A
170	氢仿		A	A	A

注1: "A" 代表满足, "B" 代表适用, "x" 不适用  
注2: 本表仅作参考, 不得作为产品选型依据和标准, 选型前请咨询相关行业专家, 否则因此造成损失, 我司概不负责。

Note 1: "A" means yes, "B" means suitable, and "X" means no  
Note 2: This table is for reference only, and cannot be used as the basis and standard of product selection. Consult relevant experts before type selection, and we will not be responsible for any loss caused by this